

create the outdoor room

Innovative all weather solutions

Australians take great delight in entertaining and relaxing outdoors. With the benefits of a retractable roofing system, you can create an outdoor enclosure that protects against the sun or rain as well as creating a cosy and private ambience.

Aluxor's Sintesi® Retractable Roofing System is designed to provide all weather protection for outdoor commercial and residential settings. Combining the best of open air living with sun, wind and rain protection, the European designed Sintesi incorporates an integrated rain gutter and downpipe system fitted discretely into the elegant mounting frame to channel water away.

The Sintesi is exclusively manufactured in Australia by Aluxor to be customised to size and specifications, and is supported by local skilled technicians.

Contemporary European design

Wind rating up to 102km/hour

Waterproof fabric and drainage system

Custom manufactured in Australia

European Standard CE UNI EN 13561 compliant

High grade materials of uncompromising quality

Able to be integrated into existing structures

Five year warranty

Sintesi Classic

Aluxor Awning Systems is a specialist manufacturer of premium, high quality retractable sunshade systems, serving customers in Australia for over 30 years.

Our products combine precision European engineering with local expertise and product knowledge, tailored to Australian conditions.

Aluxor Awnings are stylish, innovative and highly reliable, backed by a five year warranty.

Sintesi Classic - Features

Contemporary stylish design

- Incorporating contemporary European design, the Sintesi is stylish and adaptable as well as being highly functional.
- The slimline headbox houses an electronic tubular motor and gear mechanism which drives the carriage belts inside the guide rails.
- Standard and customised wall mounting plates allow a gradient adjustment from horizontal to a maximum 20° angle. A minimum of 6° to 8° angle, depending on the size, is required for water drainage.
- The guiderail and retraction design make the Sintesi suitable for wall, top, bottom, side and end fixing as well as for free-standing installations.



Guiderail operation

- The carriage operating mechanism is set within the guiderails, so concealing the mechanism when the fabric is fully extended.
- Operating inside heavy duty guiderails enables stable operation of the extension and retraction mechanism within a streamline design.
- The drive belt system is protected and fully concealed within the extruded guiderails.
- To ensure a compact fold of the fabric when retracted, there is a maximum distance of up to 700mm between intermediate fabric support windbreaks.

Integrated front gutter and downpipes

- The integrated front gutter and rainwater downpipes, housed inside the vertical mounting posts, provide an effective and discrete system for channeling water away from the roof cover.
- Water flows from the front gutter through the downpipes in the columns and is then discharged at ground level. In the event of exceptionally heavy rainfall or a drain blockage, part of the water may be directed towards the side edges of the roofing system.
- The column floor mounting system is designed to allow for balancing and adjusting to compensate for possible height differences of the fixing surface.

Retractable waterproof fabric

- The pre-constrained waterproof fabric is a high grade PVC that provides a taut finish when extended.
- The innovative drip proof edge, using parachute material welded to the fabric sides, creates a barrier to direct water towards the front gutter.
- When the roofing system is retracted the fabric gathers toward the headbox and forms a neat, compact bundle, extending approximately 180mm below the guide rails.
- A powdercoated metal cover protects the retracted fabric and is available in colours to match either the frame or fabric.

Sintesi Classic - Optional Configurations provide greater flexibility

Standard post and gutter



Wall mount with front posts

Freestanding



Free standing - single pitch

Mounted without posts

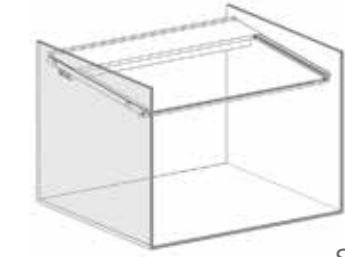

Side fix between walls

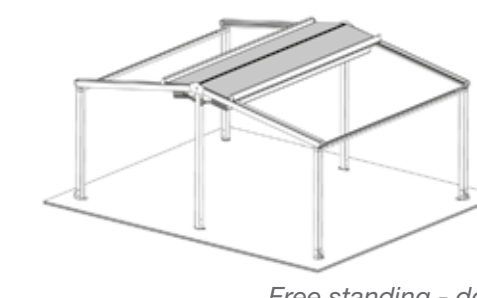

Free standing - double pitch



End fix between walls

Retrofit to existing structure



Bottom fix above existing structure

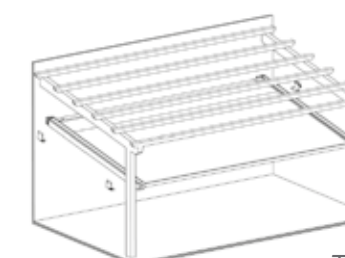

Top fix below existing structure

Installation options

The Sintesi retractable roof system provides flexible entertainment solutions. The minimal design suits contemporary and traditional architecture.

The guiderail, headbox and retraction design make it suitable for wall, end, top, bottom and side fitting to existing structures or as free-standing systems. This flexibility for installations makes the Sintesi ideal for any application.

Finishes and operation

- Pre-constrained PVC fabric in standard colours of white, grey and cream with 12 other optional colours.
- Optional pre-constrained PVC fabric in Sunblock, Grain or 3D finishes.
- Custom powdercoated extrusions and hardware from the Dulux and Interpon range.
- Remote control motor operation.
- Single unit (without intermediate posts or supports) up to 6m x 6.8m. Multiple units to 18m x 6.8m.
- Minimum 6° to 8° angle of inclination for water run off.
- The Sintesi complies with European Product Standards 2006/42/EC (Machinery), 305/2011/EC (Construction Products) and CE UNI EN 13561 (Motor Operated Awnings).

Sintesi Ghost - Leading Design in Contemporary Roofing Systems



The Sintesi Ghost is an innovative design where the individual fabric bundles retract onto spring loaded rollers housed in each of the 80mm x 80mm windbreaks.

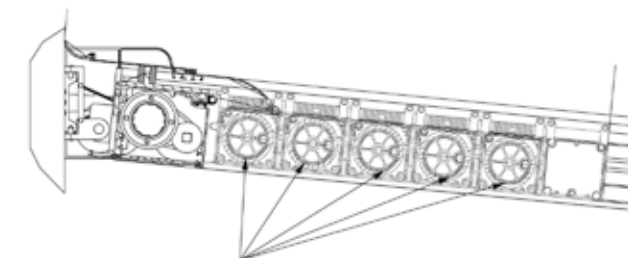

Intermediate windbreaks enclose retracted fabric

Enjoying all the design benefits and features of the Sintesi Classic, the Ghost incorporates the unique feature that when retracted the fabric bundle is fully concealed. Each windbreak acts as a storage casing for the fabric panels that extend and retract independently. This innovative feature creates an all weather compact and stylish finish.

The Sintesi Ghost can be mounted either on an existing pergola structure or installed with an integrated mounting frame. It is both clean lined and sophisticated in its design.

The maximum width and projection is 4.5m x 5.5m as a single unit and up to 13.5m x 5.5m for multiple units, with up to 1m between each intermediate windbreak.



Fabric casing with extended fabric (maximum 1m between windbreaks when extended)

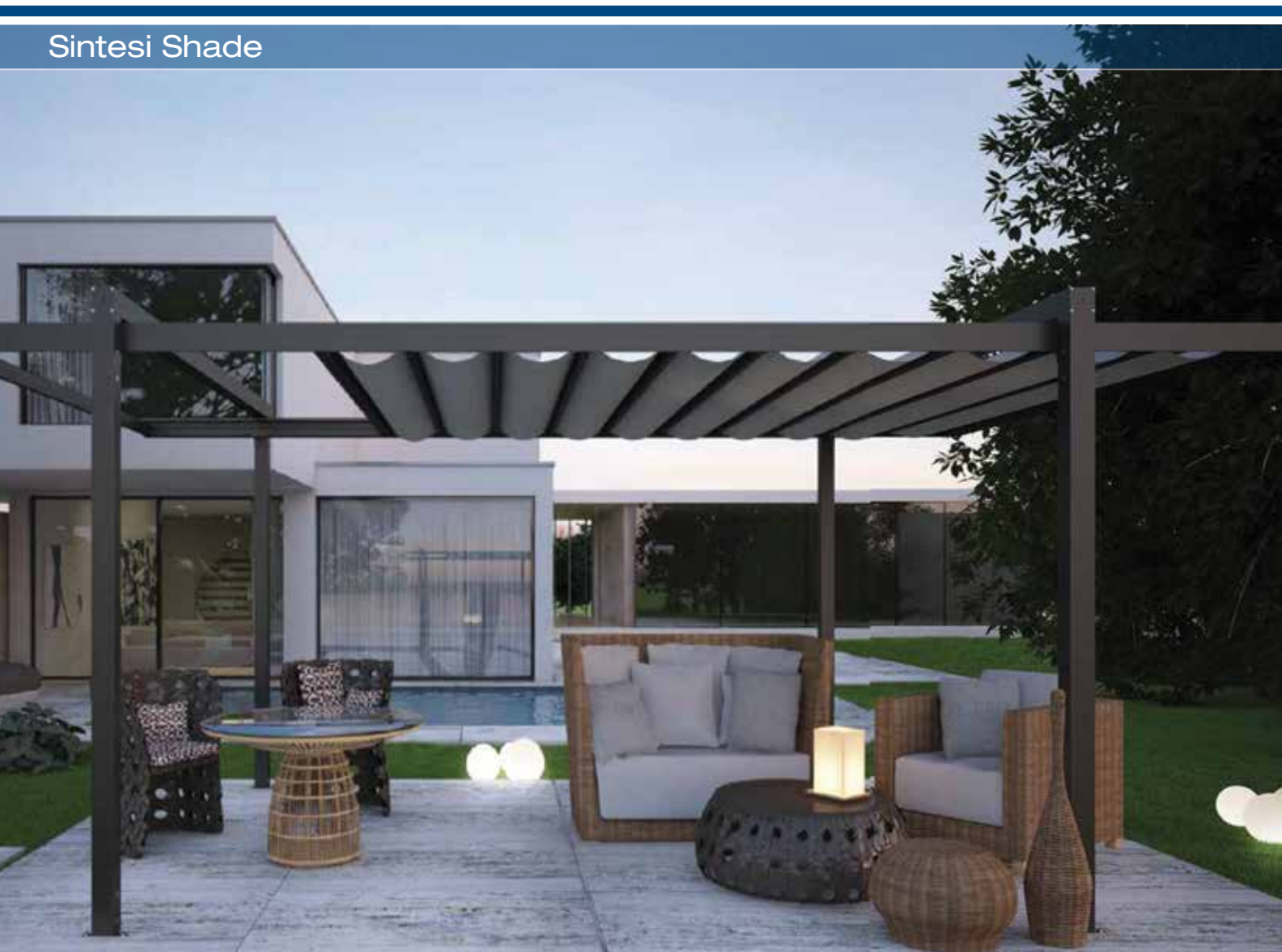

Sintesi Shade

Sintesi Shade

The Sintesi Shade is a free-standing pergola system. The horizontal position of the fabric with no angle of inclination makes it suitable for sun shade and for light rain protection.

The free standing system on posts is available in sizes up to 4.5m x 7m as a single unit or 9m x 7m as a coupled system.



Sintesi Quattro



Sintesi Quattro

The Sintesi Quattro is a free-standing unit using either the Sintesi Classic or Sintesi Ghost operating systems. The Quattro creates a stylish architectural finish to any outdoor pavilion area.

The Quattro discreetly conceals the gradient of the cover and gutter attached to the columns using modules of 400mm aluminum clad to the perimeter. The exterior is sleek and minimal with no visible fixings.

Fitted with four or six columns (depending on the size) with integrated front gutter and drains, the structure can operate with a single pitch (single or coupled units) or with a double pitch. The Quattro can also be fitted adjacent to a wall or other structure if not required to be free-standing.

The Enclosure - to complete the outdoor room

Optional fixed side panels and retractable screens can be fitted to the sides and front of the pergola structure to create an indoor enclosure to protect from wind and rain.



Side panels



Vertical screens



Heating and retrofit installation

Lighting, Heating and Sound Options

To complete the outdoor room, optional lighting features include bi-directional column spot-lights, LED's mounted on windbreaks, head box lighting options and heater and sound systems may also be fitted to the Sintesi.



Bi-directional spot-lights on columns



LED fitted to windbreak profiles



Headbox spotlights

Specifications:

	Classic	Ghost	Shade	Quattro
Width x projection				
Single unit	6000 x 6800	4500 x 5520	4500 x 7000	4500 x 5500
Multiple units	18000 x 6800	13500 x 5520	9000 x 7000	9000 x 5500
Maximum windbreak distance	700	1000	700	700 / 1000
Headbox size (height x depth)	170 x 230mm			
Guiderail dimension	85 x 65mm			
Post dimension	115 x 115mm			
Powdercoat	Customised from the Dulux or Interpon ranges			
Fabric supports	Optional powdercoat to match the fabric colour			
Standard fabrics	Preconstraint PVC white, grey, cream			
Optional fabrics	Preconstraint PVC (12 colours), Sunblock (3 colours), Grain and 3D (3 colours)			
Angle of inclination for water run-off	Minimum 6° - 8° (depending on size)			
Fabric stack depth	Approx. 180mm below the guide rail for the Sintesi Classic			
Motorised	Remote control as standard			
Wind rating	Beaufort 8 - 10 (ie. 74km/h - 102 km/h) depending on size			
Fabric cover	Powdercoated metal cover to protect the fabric when retracted			

Designs and specifications for all roof systems may be subject to change without notice



Extend your Lifestyle®
Sintesi® Retractable Roof System

Your Authorised Distributor is:



Extend your Lifestyle® with an Aluxor Awning

