

CHRISTIE

Barbecue Hood

The Evolution of the Safety Lid



A SERIES DOUBLE BBQ BENCH
with our second generation
CC2 Electric Cooktop
and barbecue hood

| | Barbecue Hood Model | |
|----------------------------|---------------------|---------|
| | Electric CC2 | Gas CC2 |
| Width | 605mm | 605mm |
| Length | 630mm | 630mm |
| Height (including bracket) | 130mm | 140mm |
| Height (above cooktop) | 75mm | 75mm |

1300 135 227
dachristie.com

Christie Barbecue Hood

The new Christie Barbecue Hood is a practical evolution of our popular safety lid, with enhanced benefits beyond protecting the hotplate from dirt. Tough and durable, it is specifically designed to complement the functionality and performance of your Christie CC2 cooktop.

Constant torque hinges hold the hood open at every position above 45 degrees – allowing seated users of all abilities to open and close the lid during the cooking process.

The curved design, in combination with the recessed hotplate, creates ample clearance to cook with the hood down. This traps radiant heat, thus reducing power consumption, allowing you to cook faster, and enhancing the flavour of the cooked food. The sleek stainless steel outer surface is easy to clean, while the inner aluminium panel reflects heat back to the food on the hotplate during the cooking process.

Trapping radiant heat not only improves the overall cooking experience, it also keeps the outer surface of the hood from reaching harmful temperatures – in fact you can safely touch the hood during any stage of the barbecue cooking cycle.

Features and benefits

Tough, durable Glass Reinforced Nylon handle remains cool to the touch at all times

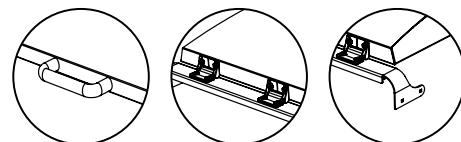

Soft close hinges and rubber bumpers for quiet operation and reduced wear and tear

Prevents ingress of water into the fat tray when barbecue is not in use, thus reducing cleaning and maintenance costs

Stainless steel, aluminium, and nylon construction for ultimate durability and corrosion resistance

Heat reflective inner aluminium panel improves cooking efficiency by up to 25%

Dual skin insulation prevents outer panel from reaching harmful temperatures

95mm - 55mm clearance allows you to cook with the hood down, trapping heat and flavour

Corrosion resistant aluminium alloy hinges, tested to over 20,000 cycles



Factory fitted upon request. Mounting bracket available for retro-fit to CC2 Cooktop models only.