



**SOLIDAL® PMP**  
Perforated Metal Pressed Screens  
**U1-100 Details**

**INDEX:**

---

**U1-100**

U1-100 Vertical Joint Detail	1
U1-100 External Corner Detail	2
U1-100 Internal Corner Detail	3
Module Perforation Detail	4

---

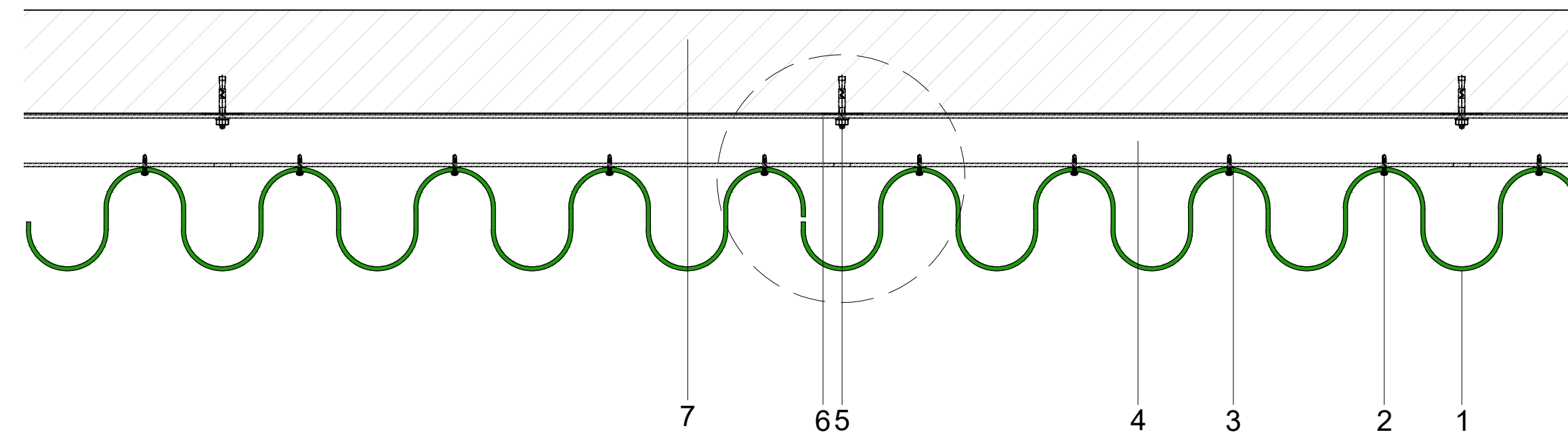

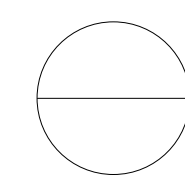
**PMP U1-100 Vertical Joint**  
 1 : 1

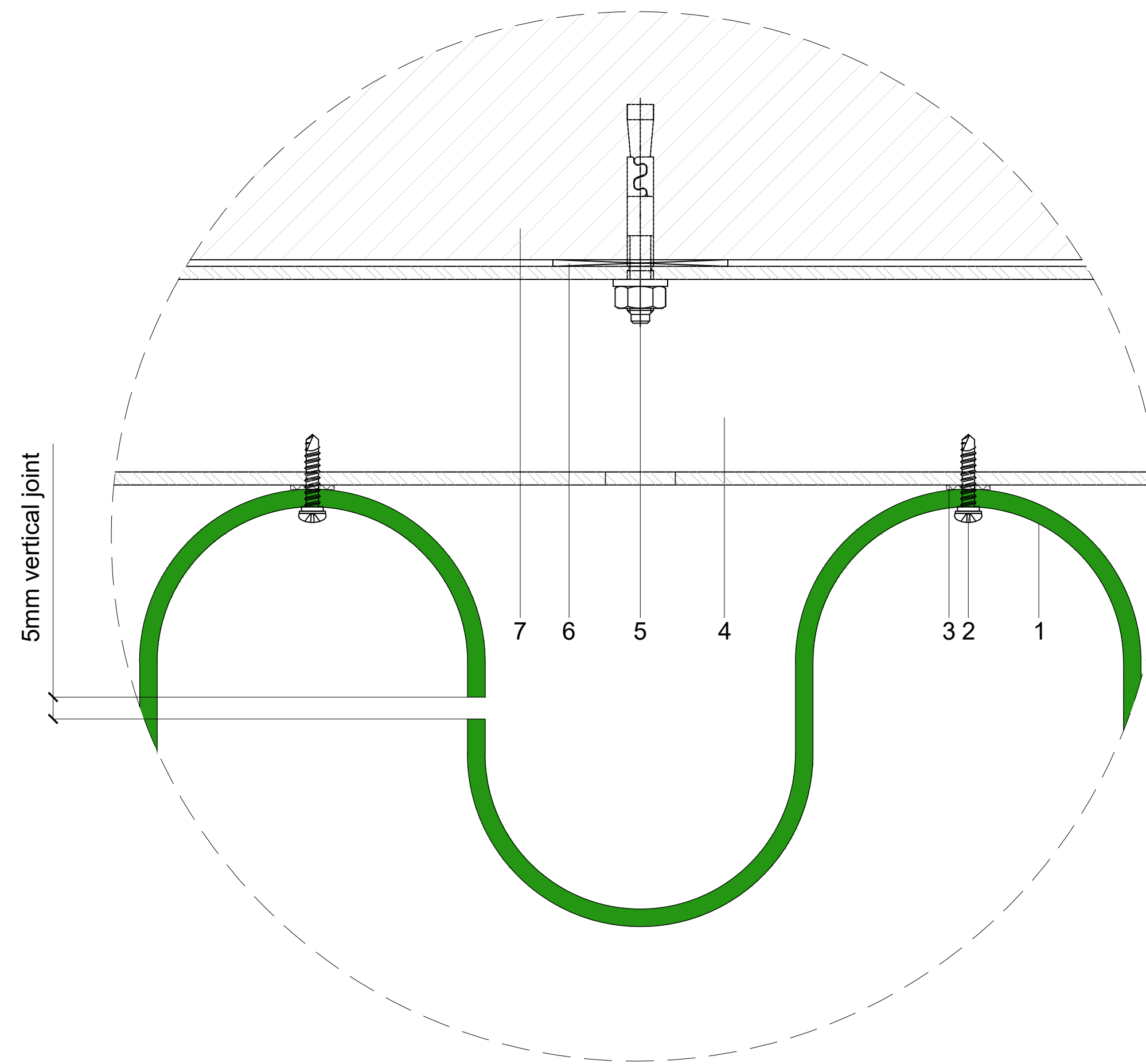

**PMP U1-100 Vertical Joint Detail**  
 1 : 5

**SOLIDAL® PMP U1-100**  
 Perforated Metal Pressed  
 Vertical Joint - Typical Detail

- 1 SOLIDAL® PMP T2® | T3® | T4®
- 2 S/S Metal Tek screw w/ EPDM Gasket
- 3 Isolation Barrier
- 4 Powder Coated RHS Support Frame
- 5 Anchor Bolt
- 6 Packing as required
- 7 Building Structure

**NOTE:**

All design related drawings and concepts are property of SOLIDAL®.  
Protected under Copyright Law.

PAGE:

**1**

DWG NAME:

SOLIDAL® PMP U1-100  
Vertical Joint Detail

SCALE:

1:1 & 1:5 @ A1

DATE:

21 / JUN / 2023

**PMP**  
**SOLIDAL®**

**SOLIDAL® PMP U1-100**  
Perforated Metal Pressed  
External Corner 90° Detail

- 1 SOLIDAL® PMP T2® | T3® | T4®
- 2 S/S Metal Tek screw w/ EPDM Gasket
- 3 Isolation Barrier
- 4 Powder Coated RHS Support Frame
- 5 Anchor Bolt
- 6 Packing as required
- 7 Building Structure
- 8 SOLIDAL® PMP EC (External Corner) Module

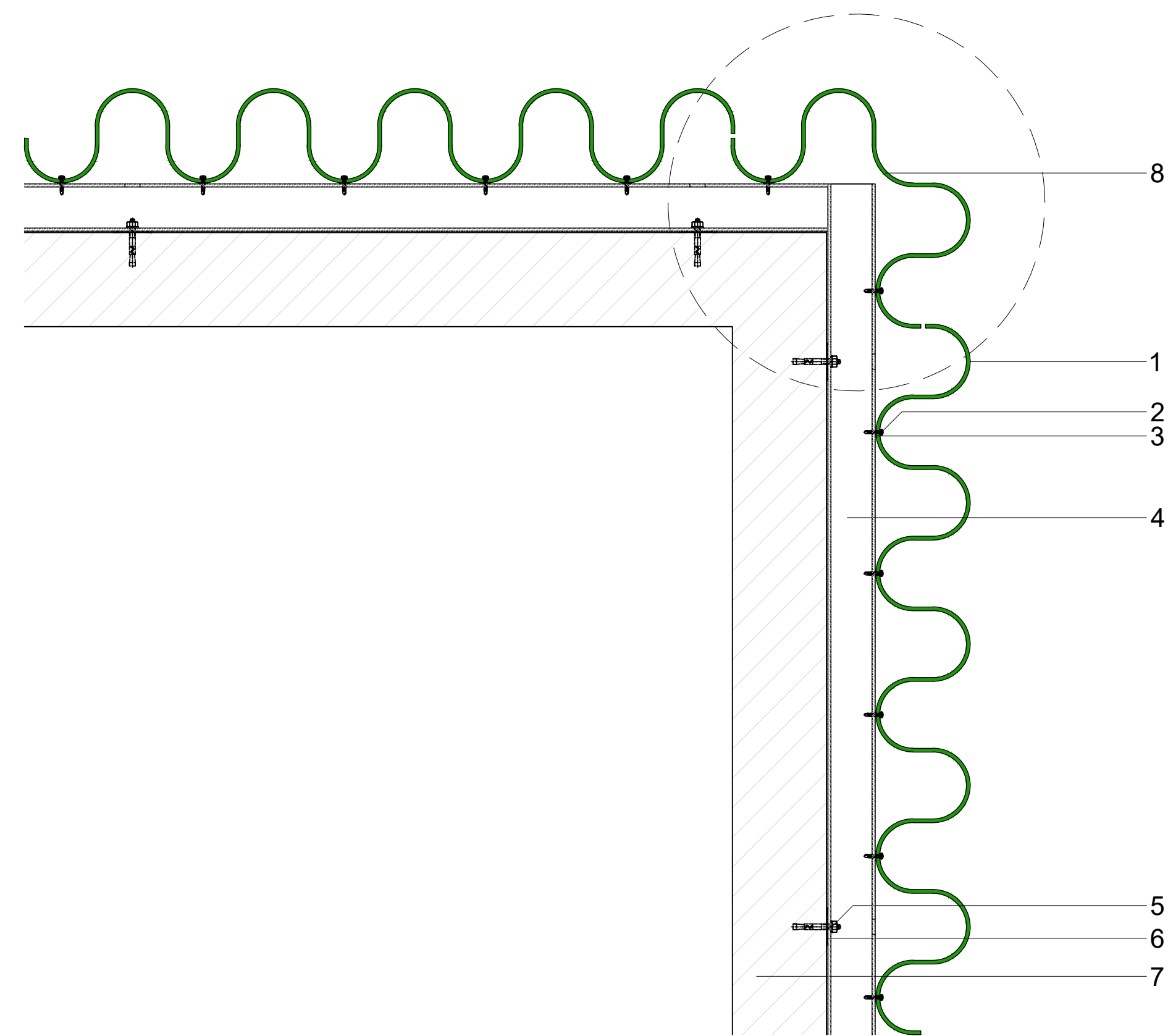

○ PMP U1-100 External Corner 90°  
1 : 1

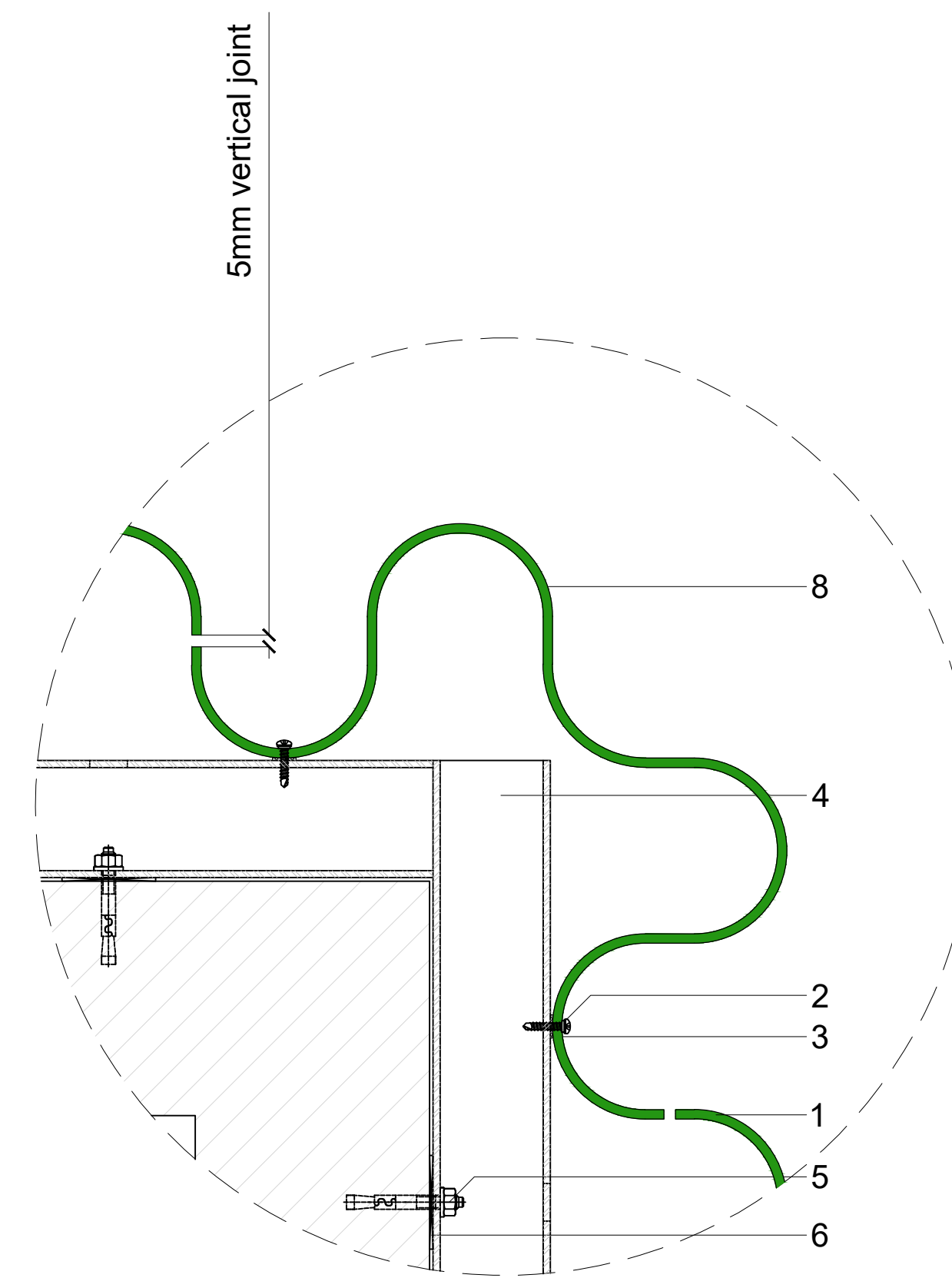

○ PMP U1-100 External Corner 90° Standard Detail  
1 : 2

**NOTE:**

All design related drawings and concepts are property of SOLIDAL®.  
Protected under Copyright Law.

**PAGE:**

**2**

**DWG NAME:**

SOLIDAL® PMP U1-100  
External Corner 90° Details

**SCALE:**

1:1 & 1:2 @ A1

**DATE:**

21 / JUN / 2023

**PMP**  
**SOLIDAL®**

**SOLIDAL® PMP U1-100**  
Perforated Metal Pressed  
Internal Corner 90° Detail

- 1 SOLIDAL® PMP T2® | T3® | T4®
- 2 S/S Metal Tek screw w/ EPDM Gasket
- 3 Isolation Barrier
- 4 Powder Coated RHS Support Frame
- 5 Anchor Bolt
- 6 Packing as required
- 7 Building Structure
- 8 SOLIDAL® PMP EC (External Corner) Module

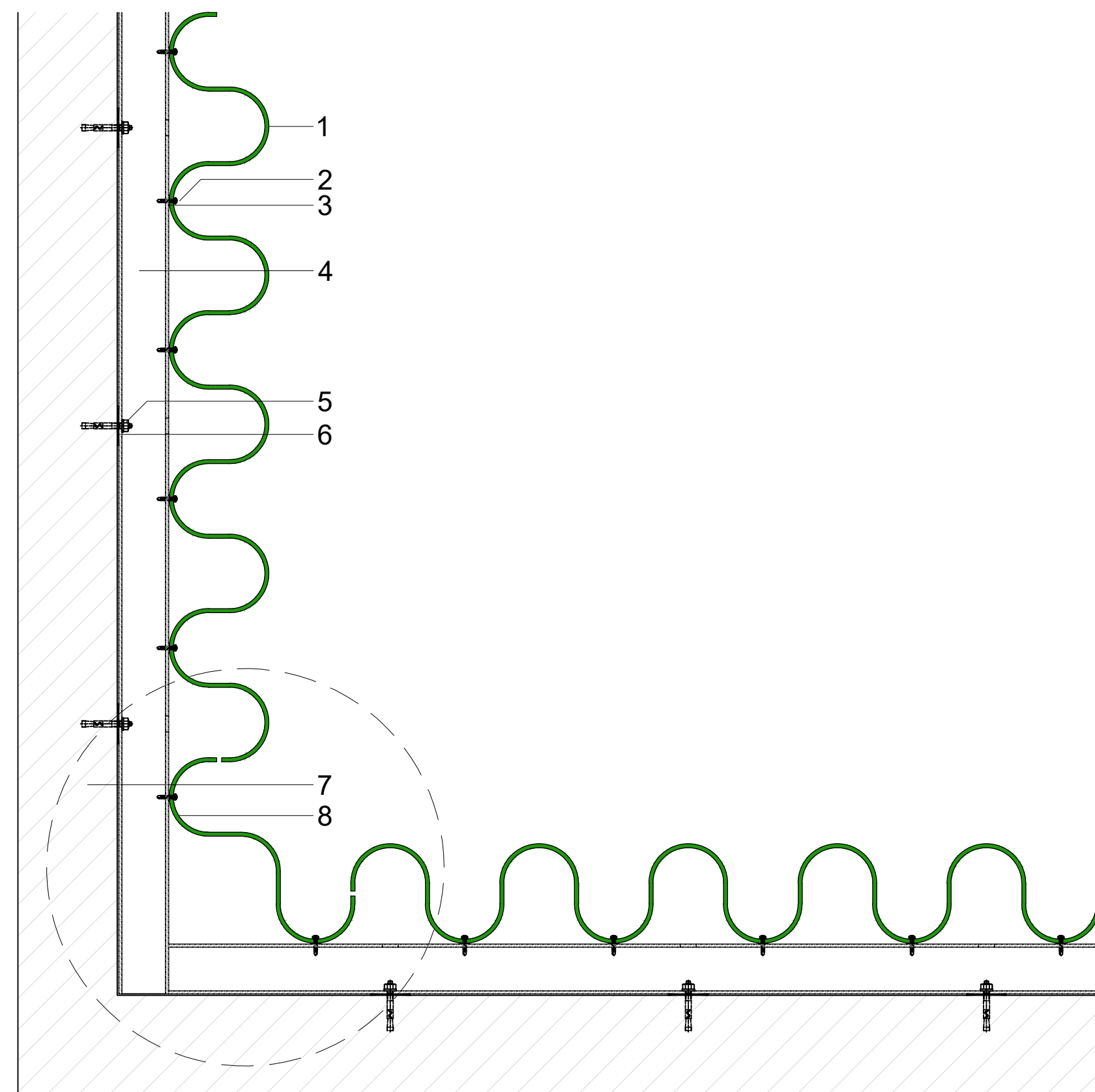

○ PMP U1-100 Internal Corner 90°  
1 : 1

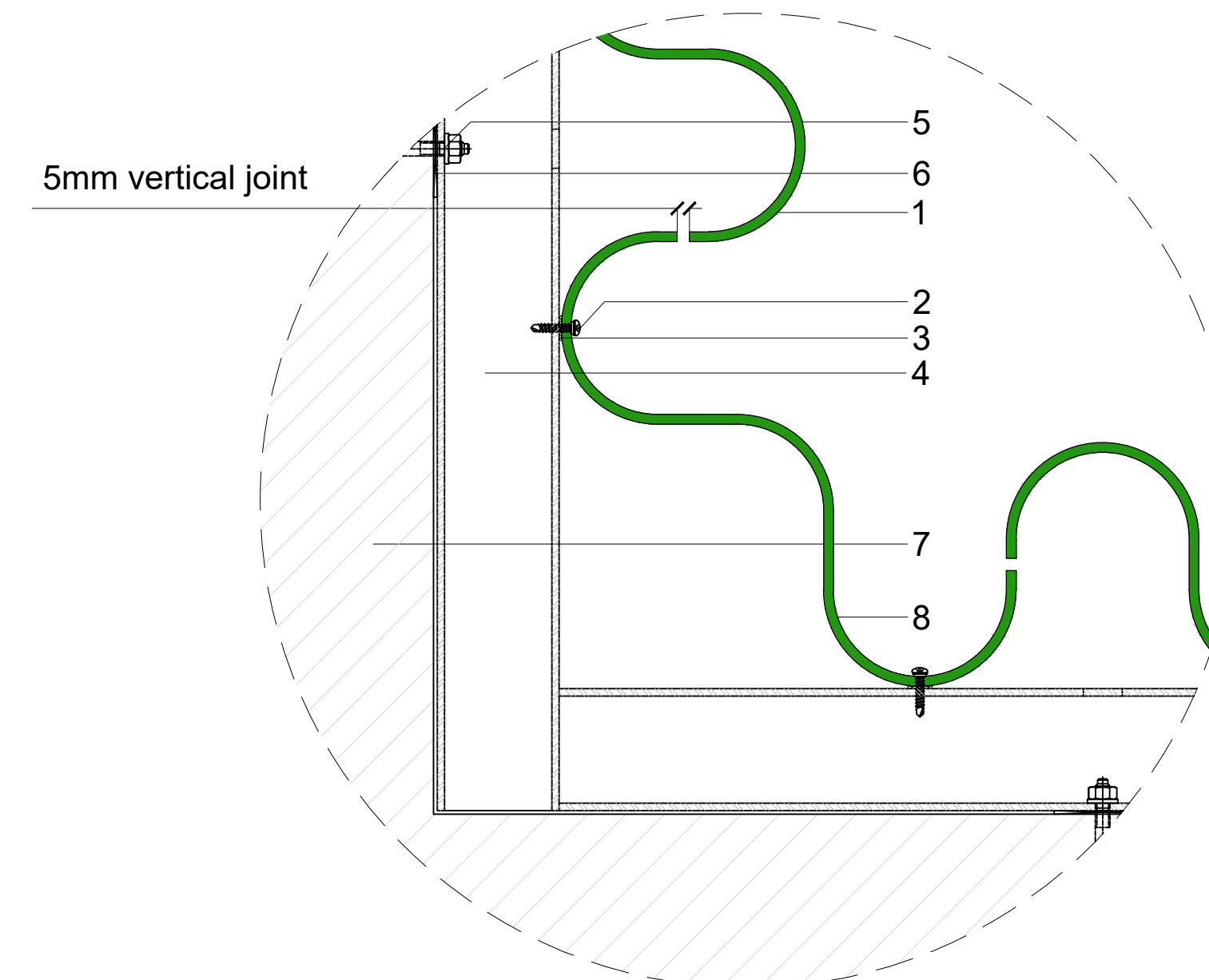

○ PMP U1-100 Internal Corner 90° Standard Detail  
1 : 2

**NOTE:**  
All design related drawings and concepts are property of SOLIDAL®.  
Protected under Copyright Law.

**PAGE:**  
**3**

**DWG NAME:**  
SOLIDAL® PMP U1-100  
Internal Corner Details

**SCALE:**  
1:1 & 1:2 @ A1  
**DATE:**  
21 / JUN / 2023

**PMP**  
**SOLIDAL®**

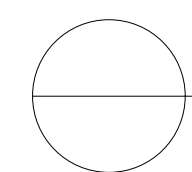
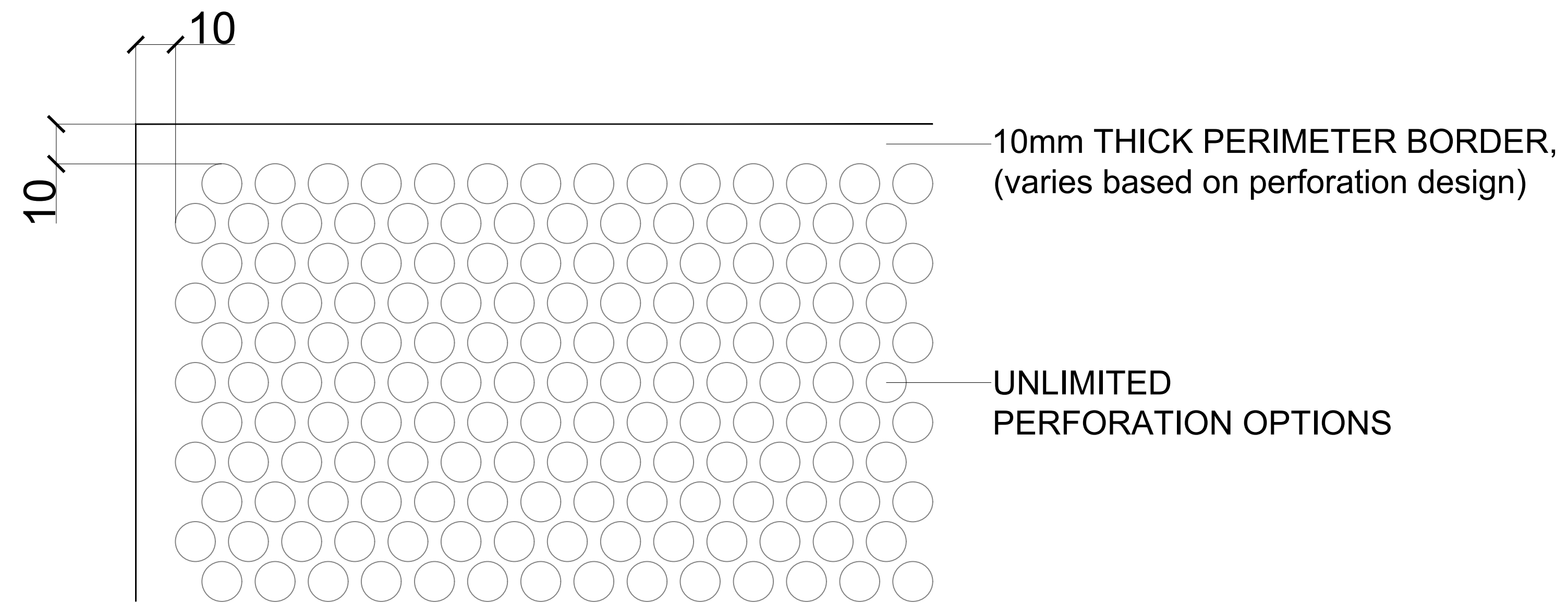

1:5

MODULE PERFORATION  
BORDER DETAILS

NOTE:

All design related drawings and concepts are property of SOLIDAL®.  
Protected under Copyright Law.

PAGE:

4

DWG NAME:

Module Perforation Details

SCALE:

1:5 @ A1

DATE:

21 / JUN / 2023

PMP

SOLIDAL®

# SOLIDAL<sup>®</sup>

## HEAD OFFICE

10/450 Elizabeth Street,  
Surry Hills, Sydney,  
NSW, Australia 2010

1300 252 325  
info@solidal.com

solidal.com

### **DISCLAIMER:**

All design related drawings and concepts are property of SOLIDAL<sup>®</sup>.  
Protected under Copyright Law.

SOLIDAL<sup>®</sup> PMP<sup>®</sup> is designed as a rainscreen cladding system.

Separation barrier to be used between dissimilar metals.

For SOLIDAL<sup>®</sup> Custom PMP<sup>®</sup> Modules, please discuss with SOLIDAL<sup>®</sup> representative.



**SOLIDAL® PMP**  
Perforated Metal Pressed Screens  
**U1-148 Details**



**INDEX:**

---

**U1-148**

U1-148 Vertical Joint Detail	1
U1-148 External Corner Detail	2
U1-148 Internal Corner Detail	3
Module Perforation Detail	4

---

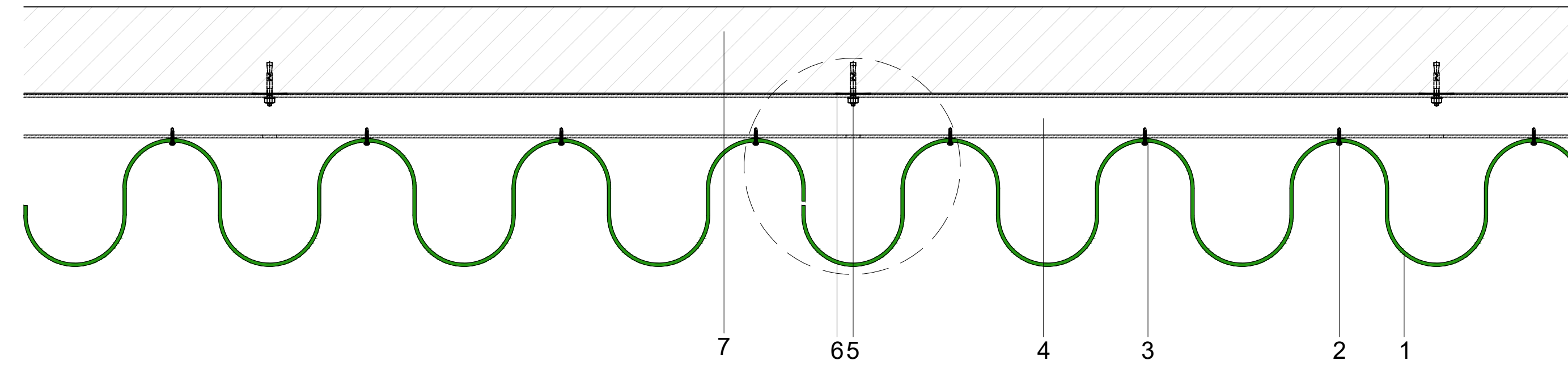

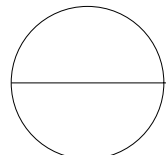
**PMP U1-148 Vertical Joint**  
 1:1

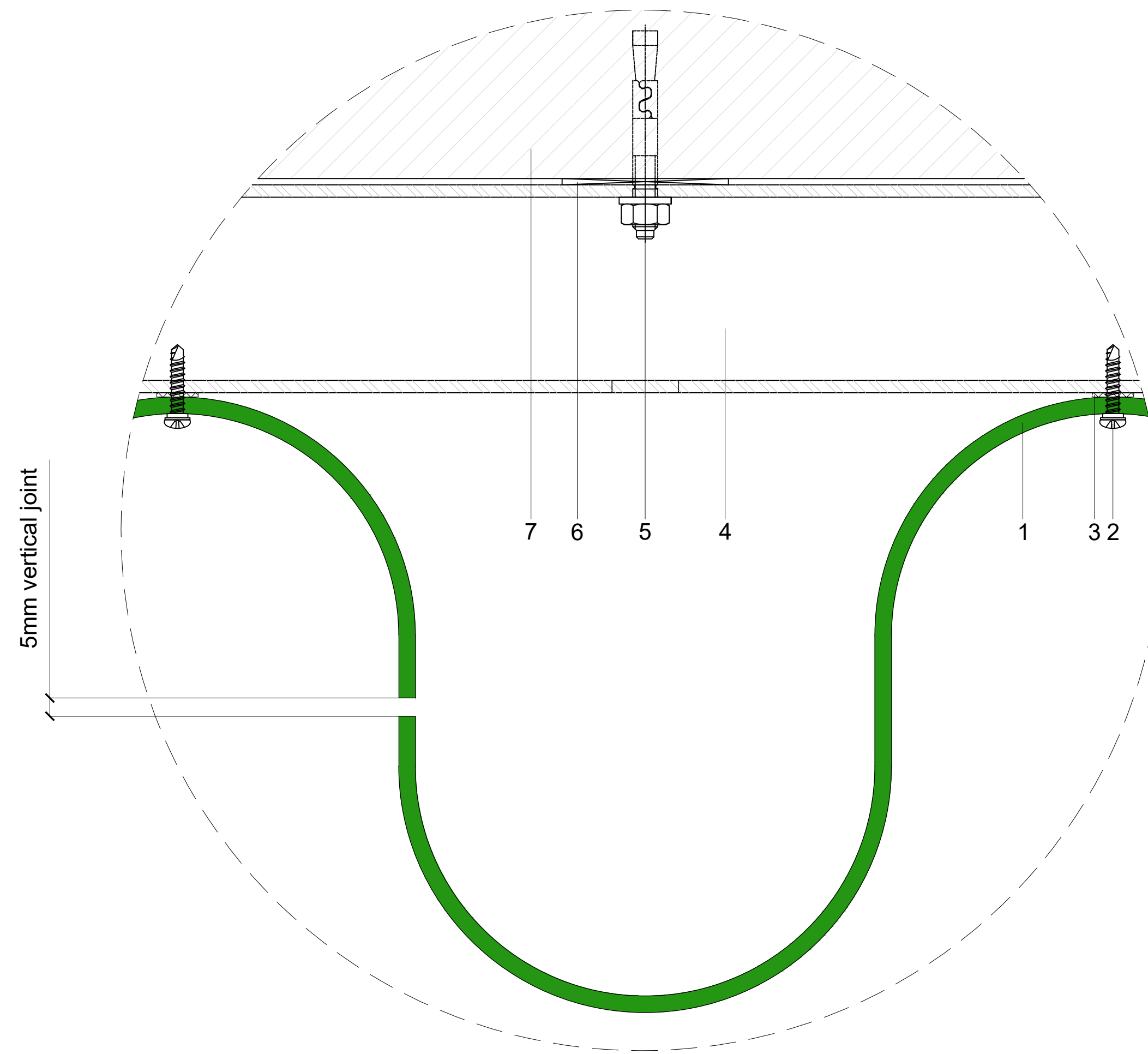

**SOLIDAL® PMP U1-148**  
 Perforated Metal Pressed  
 Vertical Joint - Typical Detail

- 1 SOLIDAL® PMP T2® | T3® | T4®
- 2 S/S Metal Tek screw w/ EPDM Gasket
- 3 Isolation Barrier
- 4 Powder Coated RHS Support Frame
- 5 Anchor Bolt
- 6 Packing as required
- 7 Building Structure

**PMP U1-148 Vertical Joint Detail**  
 1:5

**NOTE:**  
All design related drawings and concepts are property of SOLIDAL®.  
Protected under Copyright Law.

**PAGE:**  
**1**

**DWG NAME:**  
SOLIDAL® PMP U1-148  
Vertical Joint Detail

**SCALE:**  
1:1 & 1:5 @ A1  
**DATE:**  
21 / JUN / 2023

**PMP**  
**SOLIDAL®**

**SOLIDAL® PMP U1-148**  
Perforated Metal Pressed  
External Corner 90° Detail

- 1 SOLIDAL® PMP T2® | T3® | T4®
- 2 S/S Metal Tek screw w/ EPDM Gasket
- 3 Isolation Barrier
- 4 Powder Coated RHS Support Frame
- 5 Anchor Bolt
- 6 Packing as required
- 7 Building Structure
- 8 SOLIDAL® PMP EC (External Corner) Module

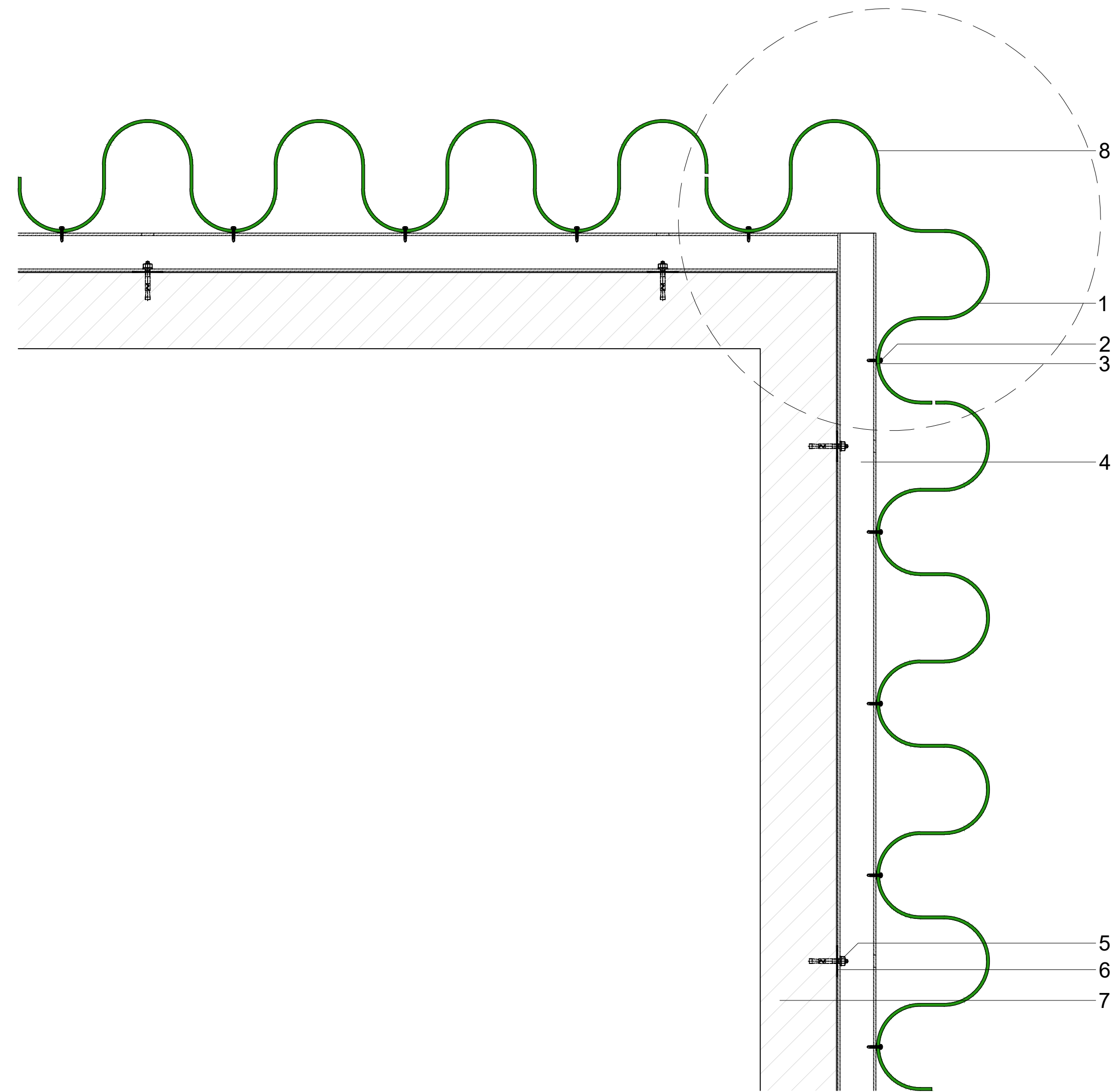

○ PMP U1-148 External Corner 90°  
1 : 1

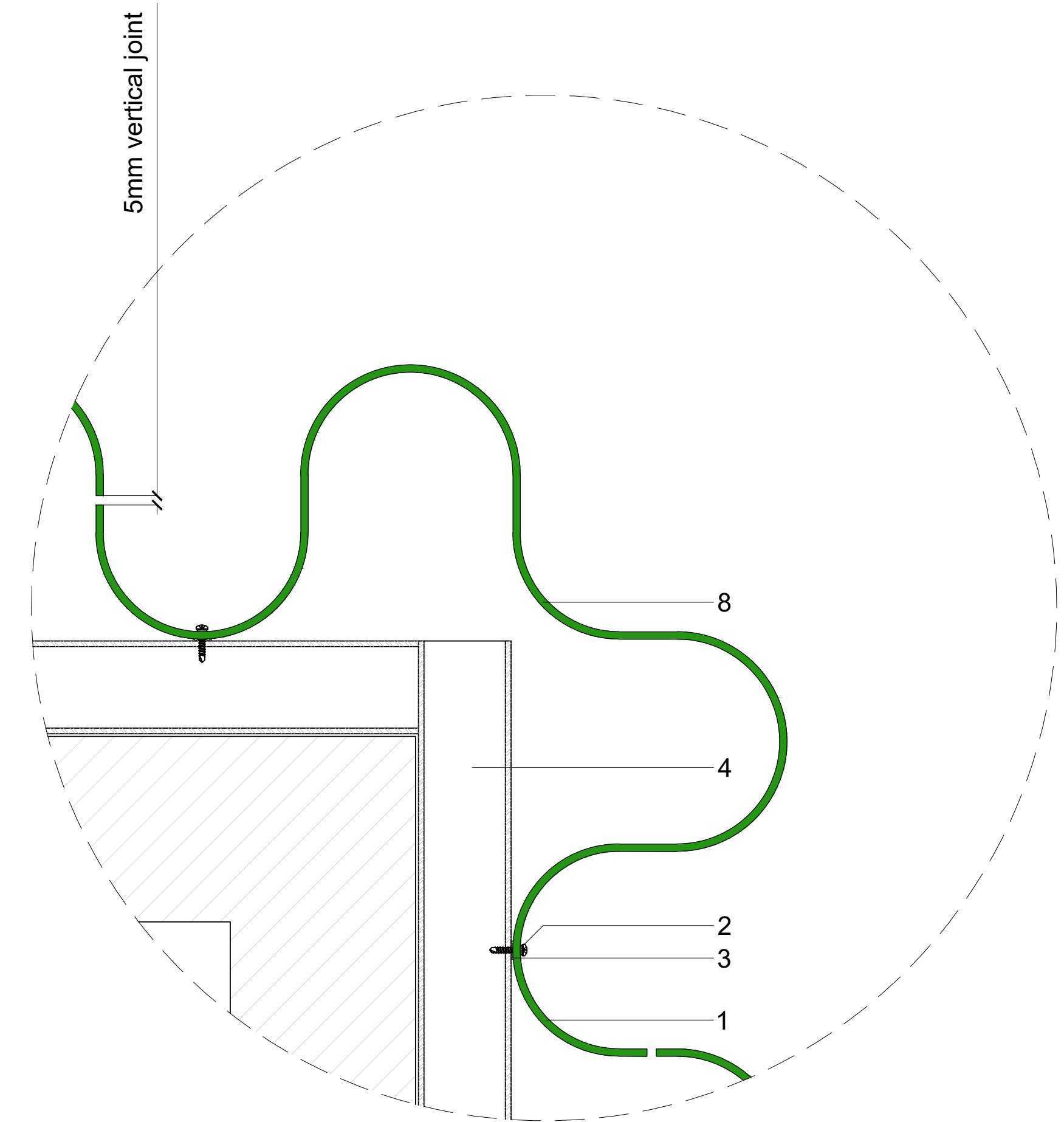

○ PMP U1-148 External Corner 90° Standard Detail  
1 : 2

**NOTE:**  
All design related drawings and concepts are property of SOLIDAL®.  
Protected under Copyright Law.

**PAGE:**  
**2**

**DWG NAME:**  
SOLIDAL® PMP U1-148  
External Corner 90° Details

**SCALE:**  
1:1 & 1:2 @ A1  
**DATE:**  
21 / JUN / 2023

**PMP**  
**SOLIDAL®**

SOLIDAL® PMP U1-148  
Perforated Metal Pressed  
Internal Corner 90° Detail

- 1 SOLIDAL® PMP T2® | T3® | T4®
- 2 S/S Metal Tek screw w/ EPDM Gasket
- 3 Isolation Barrier
- 4 Powder Coated RHS Support Frame
- 5 Anchor Bolt
- 6 Packing as required
- 7 Building Structure
- 8 SOLIDAL® PMP EC (External Corner) Module

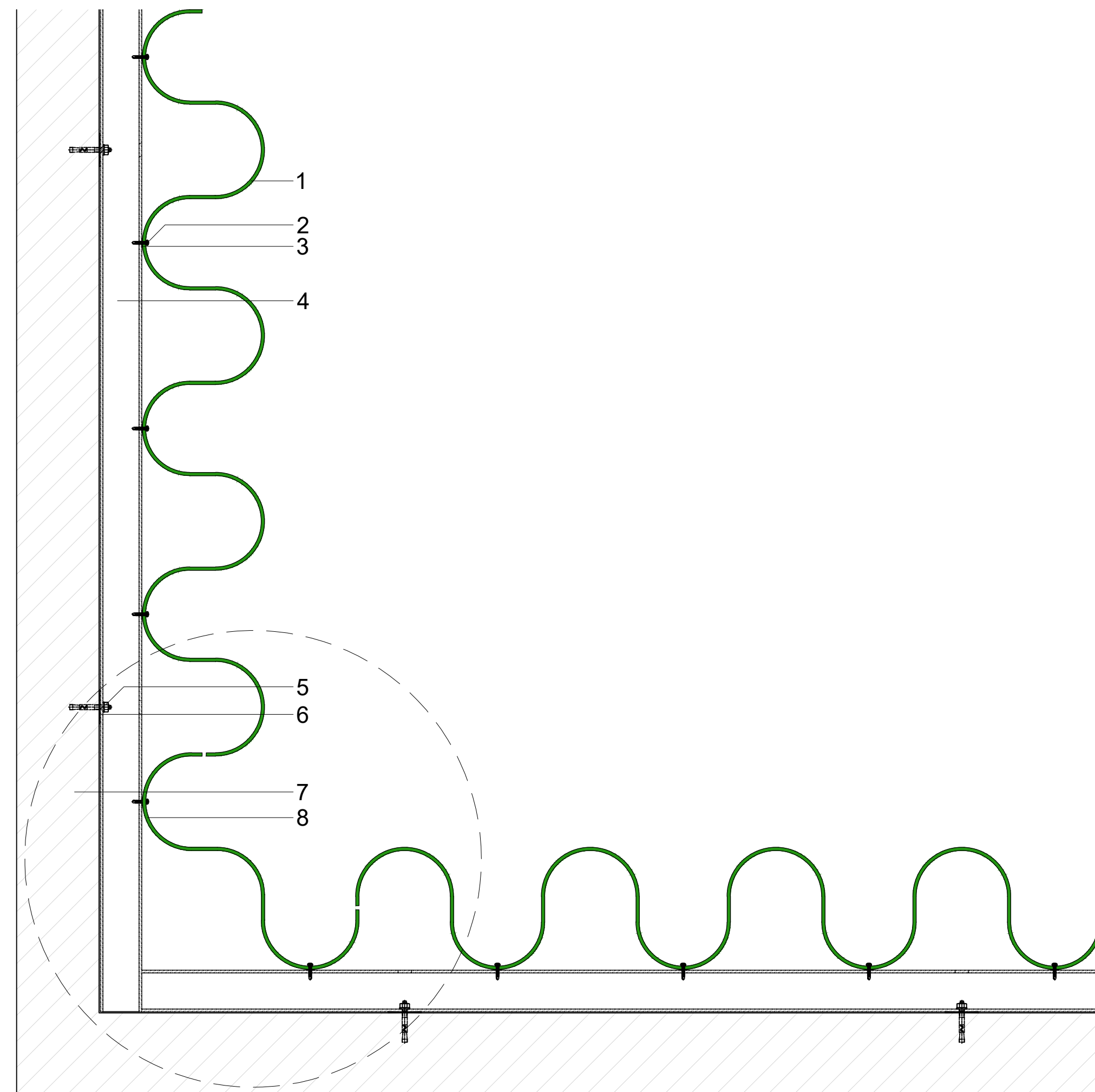

○ PMP U1-148 Internal Corner 90°  
1 : 1

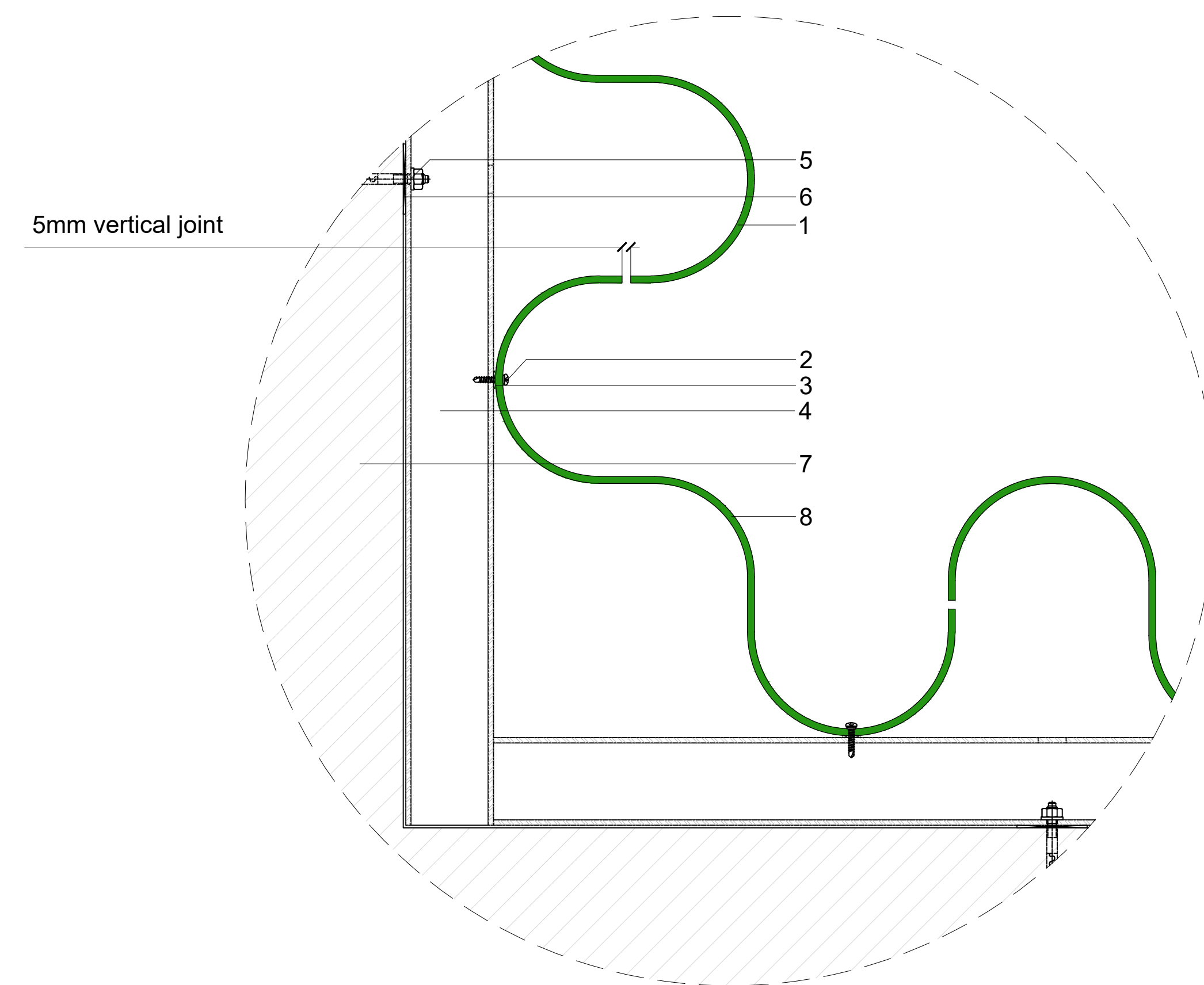

○ PMP U1-148 Internal Corner 90° Standard Detail  
1 : 2

**NOTE:**  
All design related drawings and concepts are property of SOLIDAL®.  
Protected under Copyright Law.

**PAGE:**  
**3**

**DWG NAME:**  
SOLIDAL® PMP U1-148  
Internal Corner Details

**SCALE:**  
1:1 & 1:2 @ A1  
**DATE:**  
21 / JUN / 2023

**PMP**  
**SOLIDAL®**

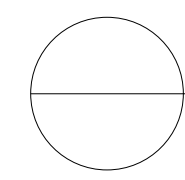
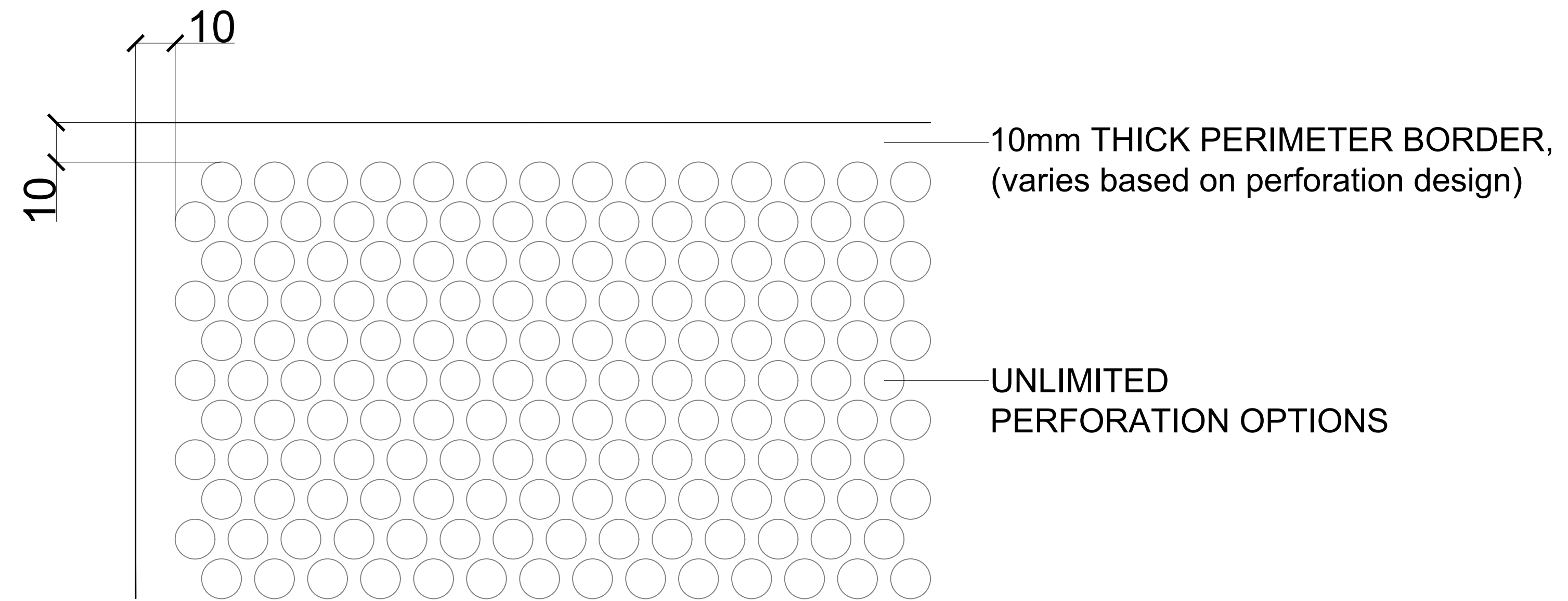

1:5

**MODULE PERFORATION  
BORDER DETAILS**

**NOTE:**

All design related drawings and concepts are property of SOLIDAL®.  
Protected under Copyright Law.

**PAGE:**

**4**

**DWG NAME:**

Module Perforation Details

**SCALE:**

1:5 @ A1

**DATE:**

21 / JUN / 2023

**PMP**

**SOLIDAL®**

# SOLIDAL<sup>®</sup>

## HEAD OFFICE

10/450 Elizabeth Street,  
Surry Hills, Sydney,  
NSW, Australia 2010

1300 252 325  
info@solidal.com

solidal.com

### DISCLAIMER:

All design related drawings and concepts are property of SOLIDAL<sup>®</sup>.  
Protected under Copyright Law.

SOLIDAL<sup>®</sup> PMP<sup>®</sup> is designed as a rainscreen cladding system.

Separation barrier to be used between dissimilar metals.

For SOLIDAL<sup>®</sup> Custom PMP<sup>®</sup> Modules, please discuss with SOLIDAL<sup>®</sup> representative.



**SOLIDAL® PMP**  
Perforated Metal Pressed Screens  
**U1-196 Details**

**INDEX:**

---

**U1-196**

U1-196 Vertical Joint Detail	1
U1-196 External Corner Detail	2
U1-196 Internal Corner Detail	3
Module Perforation Detail	4

---



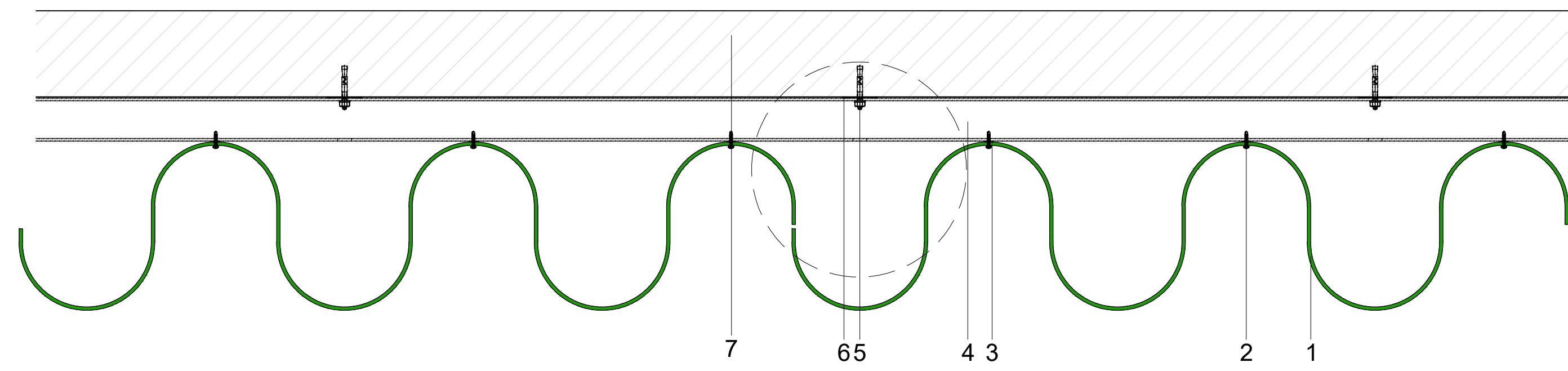

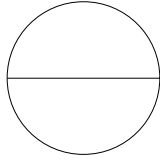
**PMP U1-196 Vertical Joint**  
 1:1

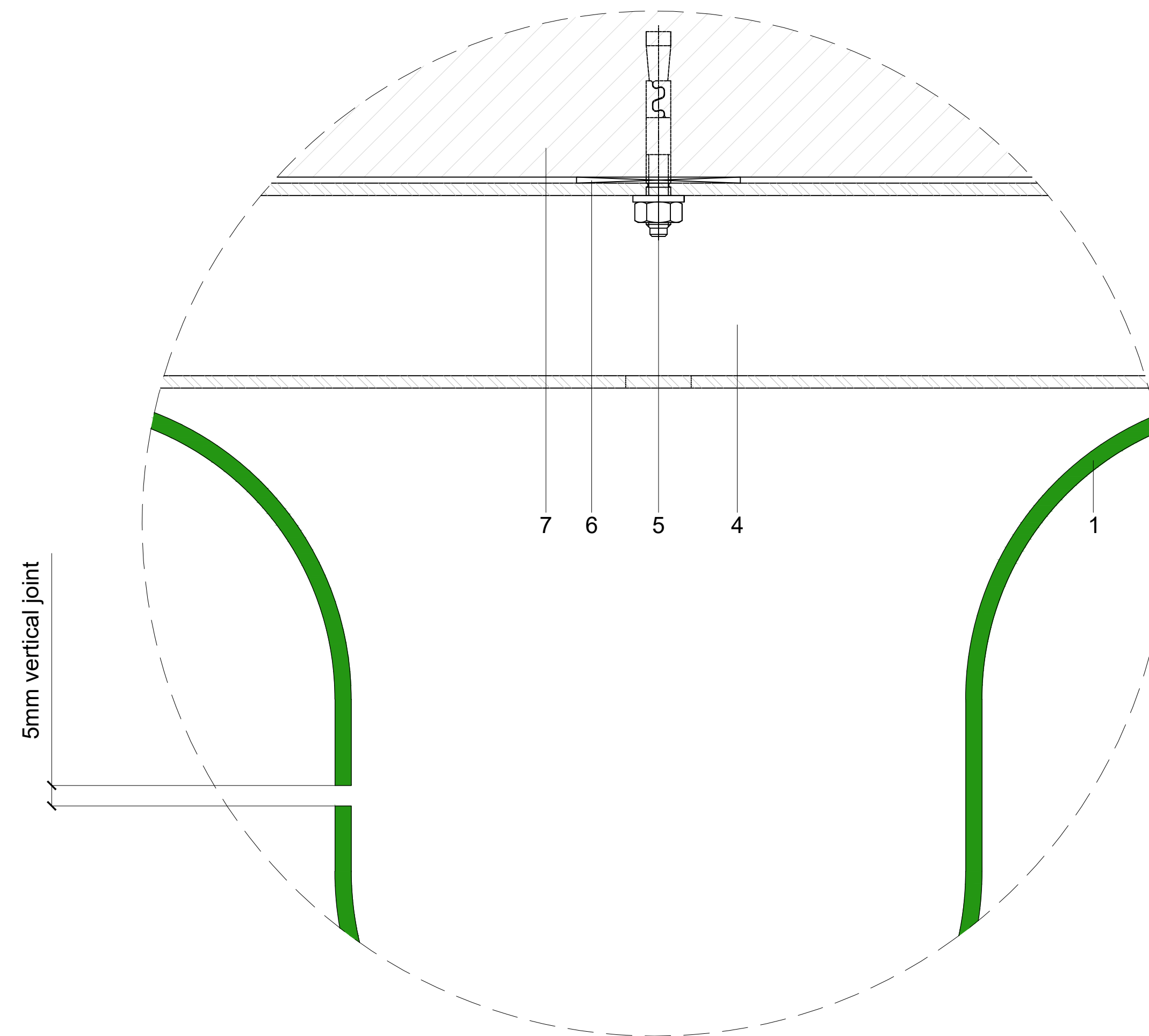

**SOLIDAL® PMP U1-196**  
 Perforated Metal Pressed  
 Vertical Joint - Typical Detail

- 1 SOLIDAL® PMP T2® | T3® | T4®
- 2 S/S Metal Tek screw w/ EPDM Gasket
- 3 Isolation Barrier
- 4 Powder Coated RHS Support Frame
- 5 Anchor Bolt
- 6 Packing as required
- 7 Building Structure

**PMP U1-196 Vertical Joint Detail**  
 1:5

<b>NOTE:</b> All design related drawings and concepts are property of SOLIDAL®. Protected under Copyright Law.	<b>PAGE:</b> <div style="font-size: 2em; font-weight: bold; text-align: center;">1</div>	<b>DWG NAME:</b> SOLIDAL® PMP U1-196 Vertical Joint Detail	<b>SCALE:</b> 1:1 & 1:5 @ A1	<div style="font-size: 1.5em; font-weight: bold;">PMP</div> <div style="font-size: 1.5em; font-weight: bold;">SOLIDAL®</div>
			<b>DATE:</b> 21 / JUN / 2023	

**SOLIDAL® PMP U1-196**  
Perforated Metal Pressed  
External Corner 90° Detail

- 1 SOLIDAL® PMP T2®|T3®|T4®
- 2 S/S Metal Tek screw w/ EPDM Gasket
- 3 Isolation Barrier
- 4 Powder Coated RHS Support Frame
- 5 Anchor Bolt
- 6 Packing as required
- 7 Building Structure
- 8 SOLIDAL® PMP EC (External Corner) Module

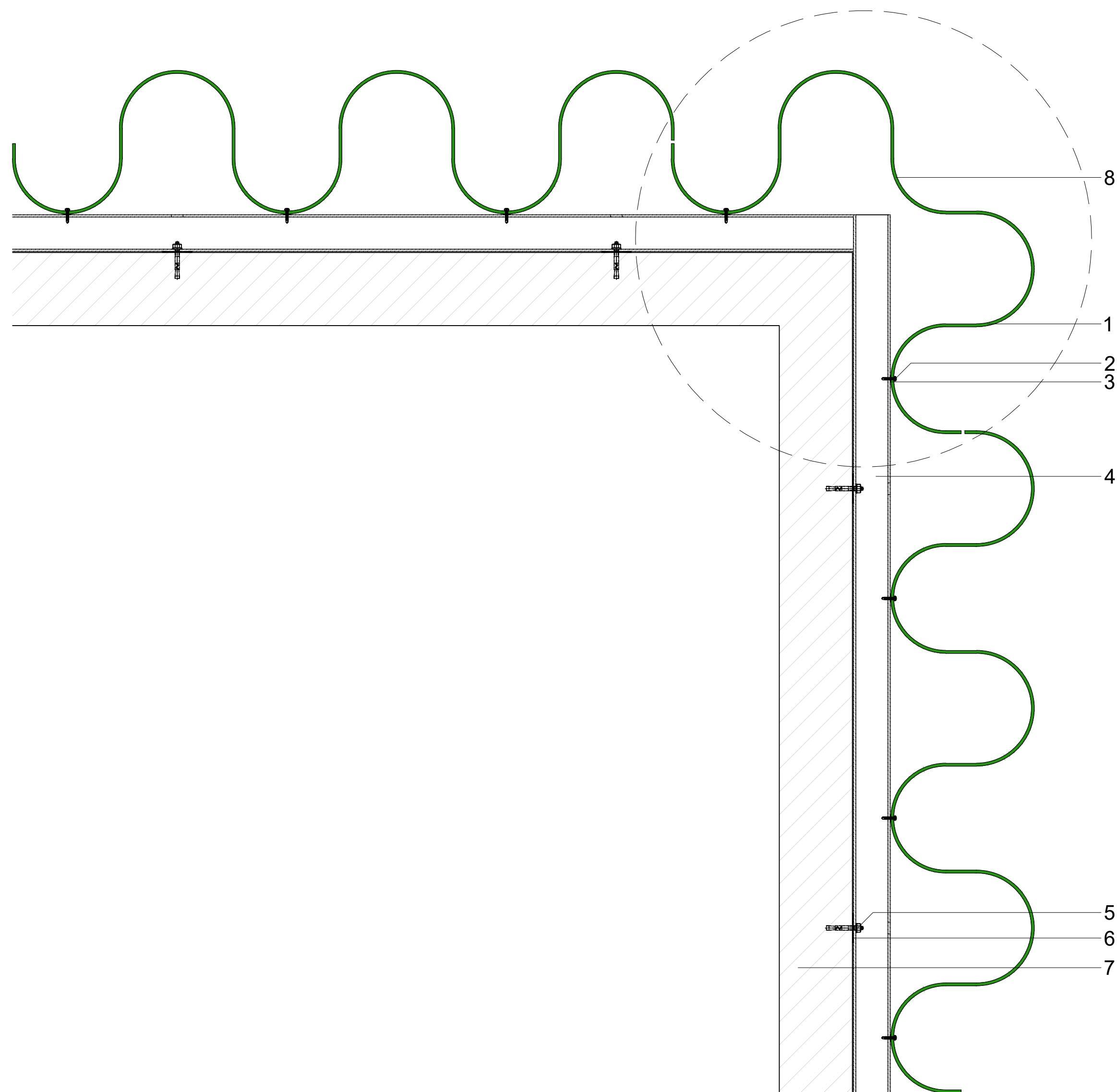

 **PMP U1-196 External Corner 90°**  
1:1

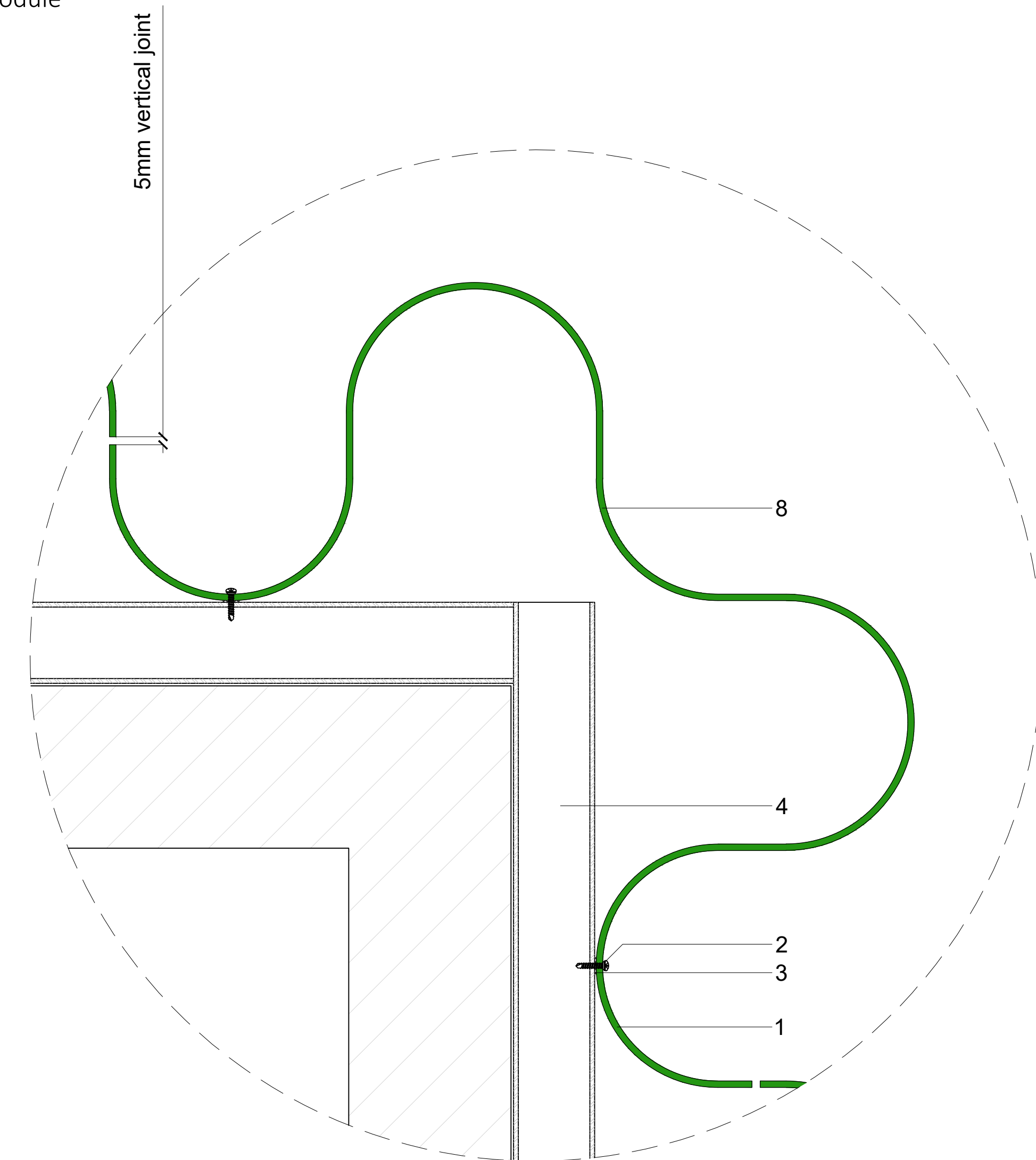

 **PMP U1-196 External Corner 90° Standard Detail**  
1:2

**NOTE:**

All design related drawings and concepts are property of SOLIDAL®.  
Protected under Copyright Law.

**PAGE:**

**2**

**DWG NAME:**

SOLIDAL® PMP U1-196  
External Corner 90° Details

**SCALE:**

1:1 & 1:2 @ A1

**DATE:**

21 / JUN / 2023

**PMP**  
**SOLIDAL®**

SOLIDAL® PMP U1-196  
Perforated Metal Pressed  
Internal Corner 90° Detail

- 1 SOLIDAL® PMP T2® | T3® | T4®
- 2 S/S Metal Tek screw w/ EPDM Gasket
- 3 Isolation Barrier
- 4 Powder Coated RHS Support Frame
- 5 Anchor Bolt
- 6 Packing as required
- 7 Building Structure
- 8 SOLIDAL® PMP EC (External Corner) Module

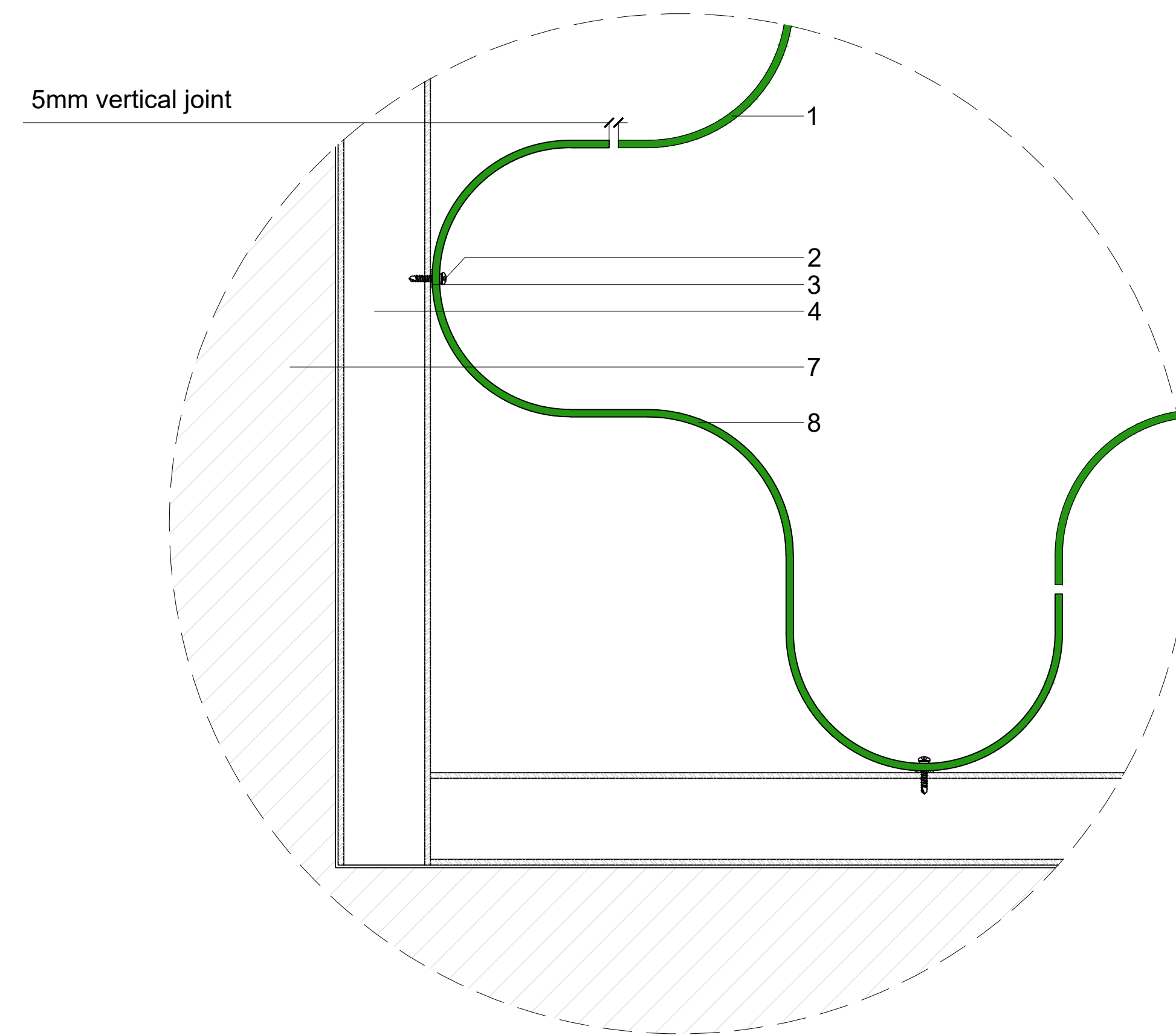
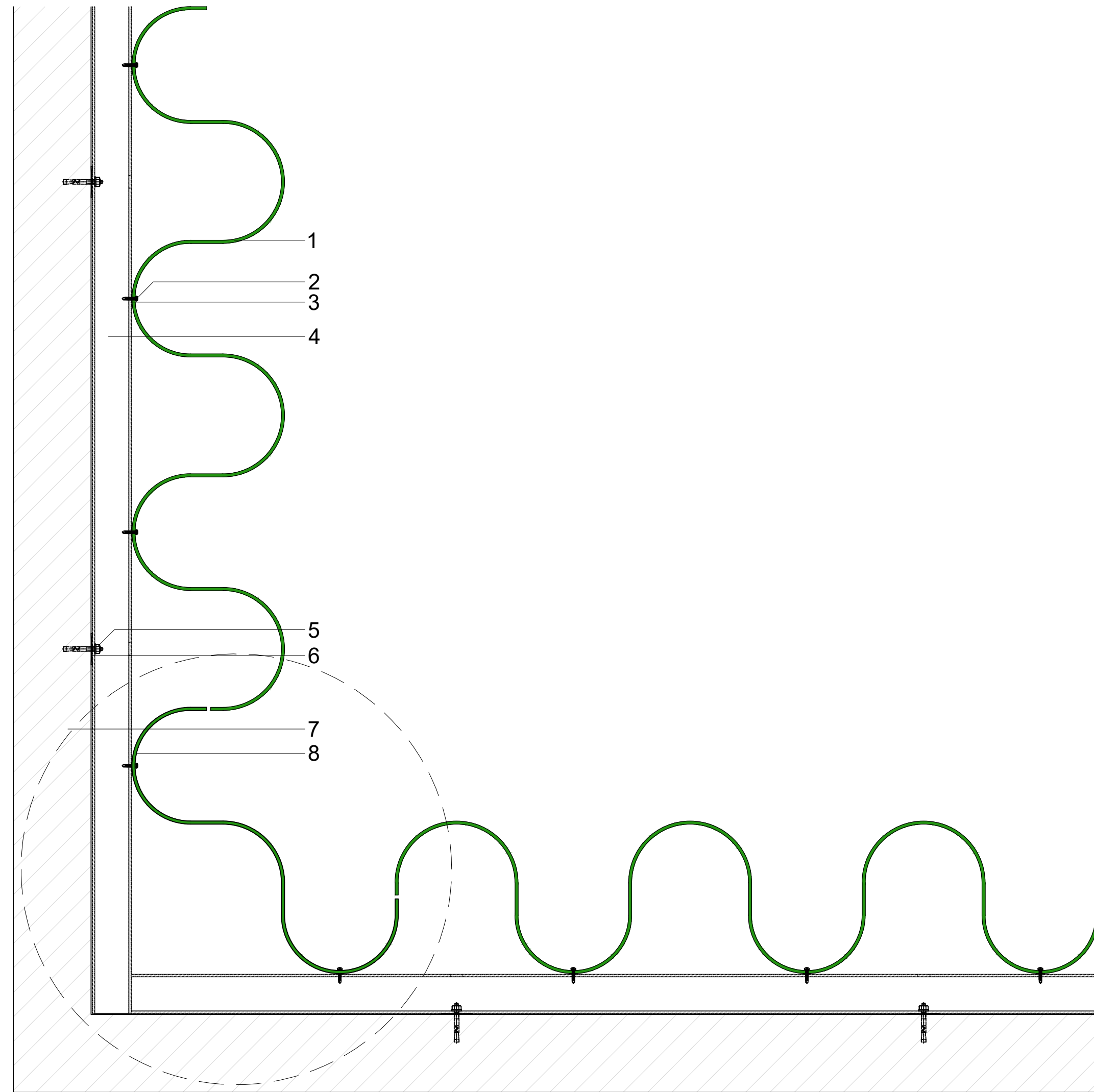

○ PMP U1-196 Internal Corner 90°  
1:1

○ PMP U1-196 Internal Corner 90° Standard Detail  
1:2

**NOTE:**  
All design related drawings and concepts are property of SOLIDAL®.  
Protected under Copyright Law.

**PAGE:**  
**3**

**DWG NAME:**  
SOLIDAL® PMP U1-196  
Internal Corner Details

**SCALE:**  
1:1 & 1:2 @ A1  
**DATE:**  
21 / JUN / 2023

**PMP**  
**SOLIDAL®**

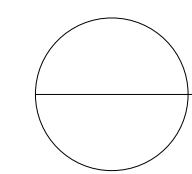
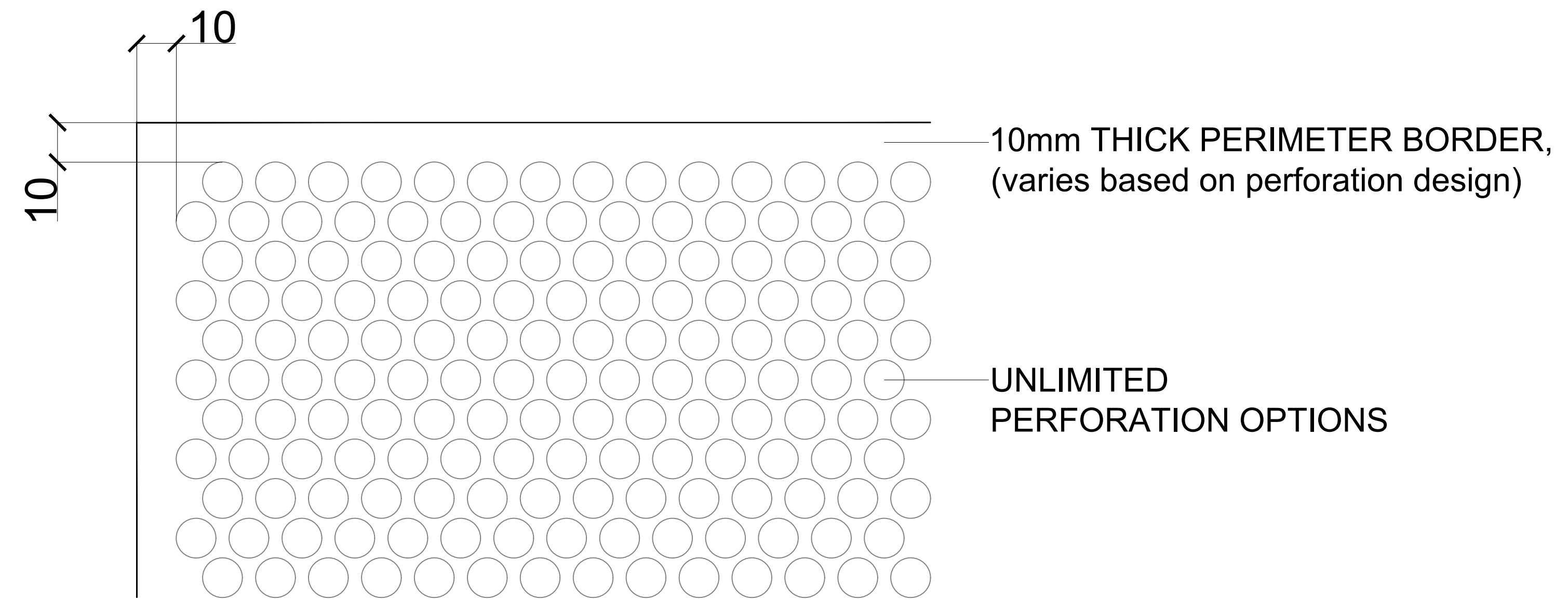

1:5

MODULE PERFORATION  
BORDER DETAILS

NOTE:

All design related drawings and concepts are property of SOLIDAL®.  
Protected under Copyright Law.

PAGE:

4

DWG NAME:

Module Perforation Details

SCALE:

1:5 @ A1

DATE:

21 / JUN / 2023

PMP

SOLIDAL®

# SOLIDAL<sup>®</sup>

## HEAD OFFICE

10/450 Elizabeth Street,  
Surry Hills, Sydney,  
NSW, Australia 2010

1300 252 325  
info@solidal.com

solidal.com

### DISCLAIMER:

All design related drawings and concepts are property of SOLIDAL<sup>®</sup>.  
Protected under Copyright Law.

SOLIDAL<sup>®</sup> PMP<sup>®</sup> is designed as a rainscreen cladding system.

Separation barrier to be used between dissimilar metals.

For SOLIDAL<sup>®</sup> Custom PMP<sup>®</sup> Modules, please discuss with SOLIDAL<sup>®</sup> representative.