



**SOLIDAL® PMP**  
Perforated Metal Pressed Screens  
**U3-145 Details**

**INDEX:**

---

**U3-145**

|                               |   |
|-------------------------------|---|
| U3-145 Vertical Joint Detail  | 1 |
| U3-145 External Corner Detail | 2 |
| U3-145 Internal Corner Detail | 3 |
| Module Perforation Detail     | 4 |

---

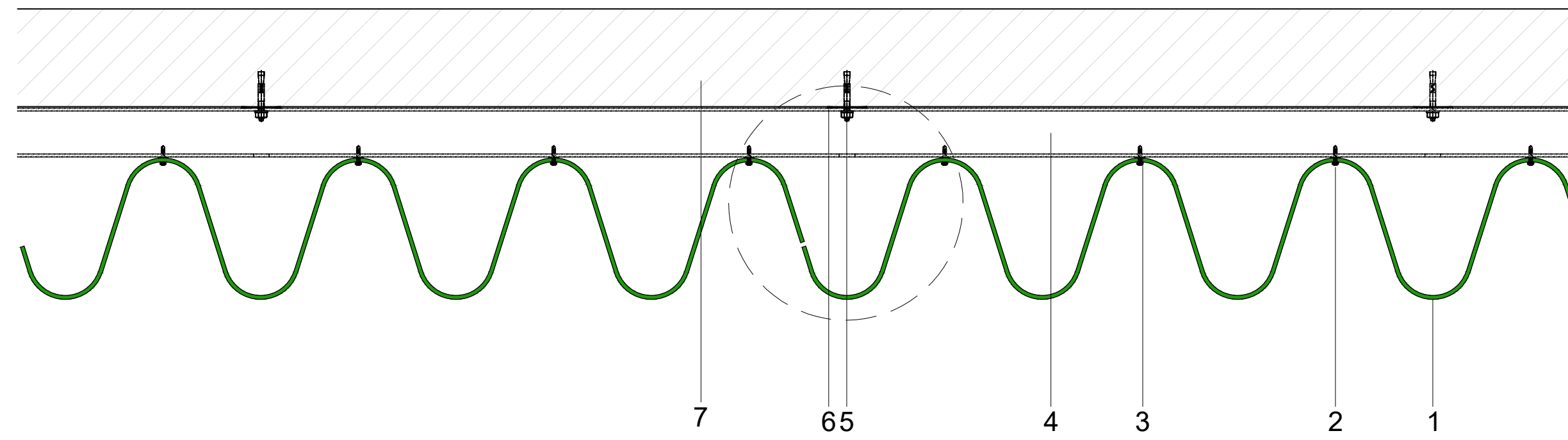

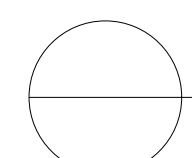
**PMP U3-145 Vertical Joint**  
 1:1

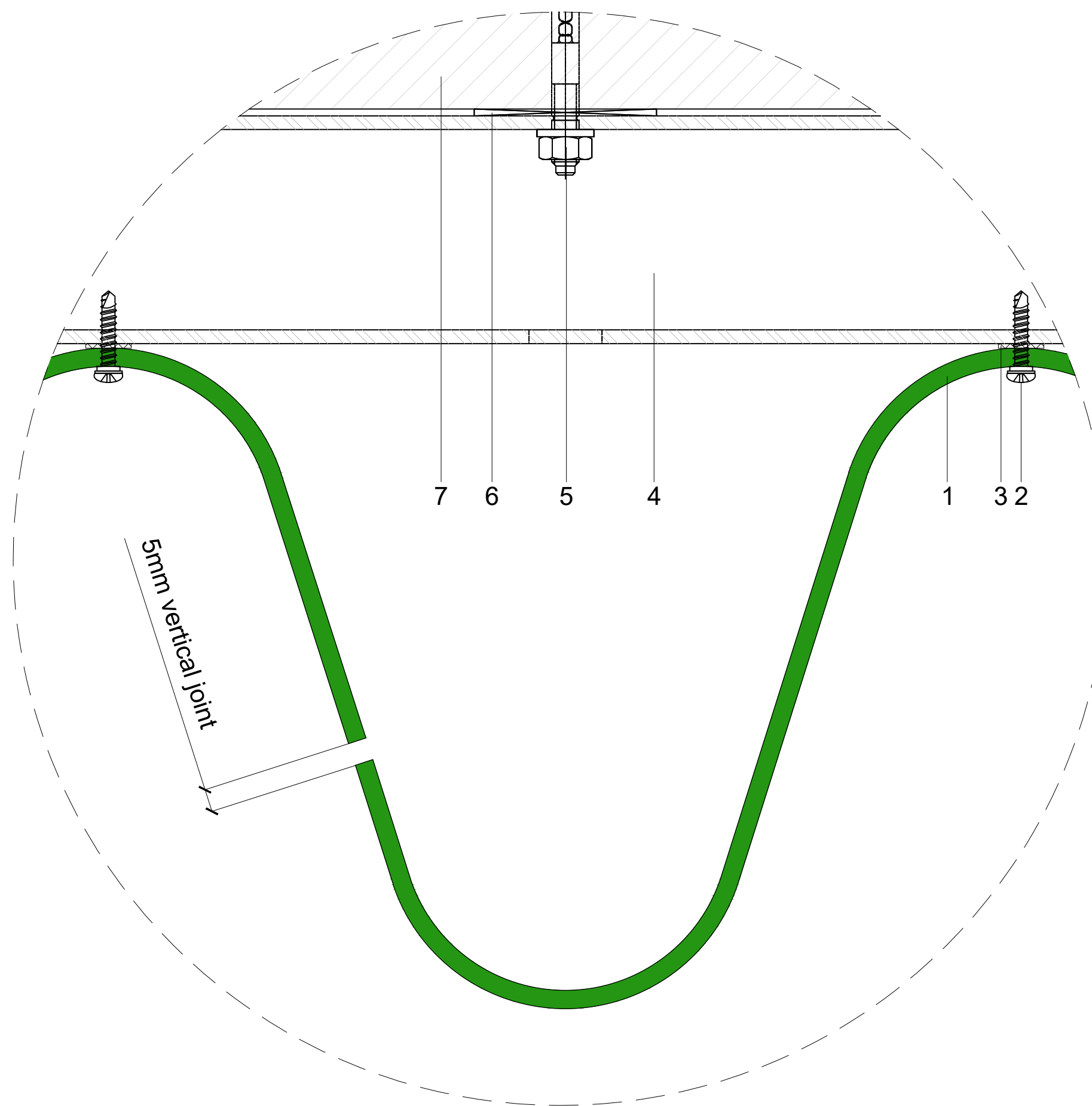

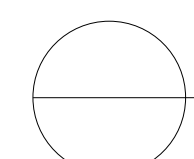
**PMP U3-145 Vertical Joint Detail**  
 1:5

**SOLIDAL® PMP U3-145**  
 Perforated Metal Pressed  
 Vertical Joint - Typical Detail

- 1 SOLIDAL® PMP T2® | T3® | T4®
- 2 S/S Metal Tek screw w/ EPDM Gasket
- 3 Isolation Barrier
- 4 Powder Coated RHS Support Frame
- 5 Anchor Bolt
- 6 Packing as required
- 7 Building Structure

**NOTE:**

All design related drawings and concepts are property of SOLIDAL®.  
Protected under Copyright Law.

PAGE:

**1**

DWG NAME:

SOLIDAL® PMP U3-145  
Vertical Joint Detail

SCALE:

1:1 & 1:5 @ A1

DATE:

21 / JUN / 2023

**PMP**  
**SOLIDAL®**

SOLIDAL® PMP U3-145  
Perforated Metal Pressed  
External Corner 90° Detail

- 1 SOLIDAL® PMP T2® | T3® | T4®
- 2 S/S Metal Tek screw w/ EPDM Gasket
- 3 Isolation Barrier
- 4 Powder Coated RHS Support Frame
- 5 Anchor Bolt
- 6 Packing as required
- 7 Building Structure
- 8 SOLIDAL® PMP EC (External Corner) Module

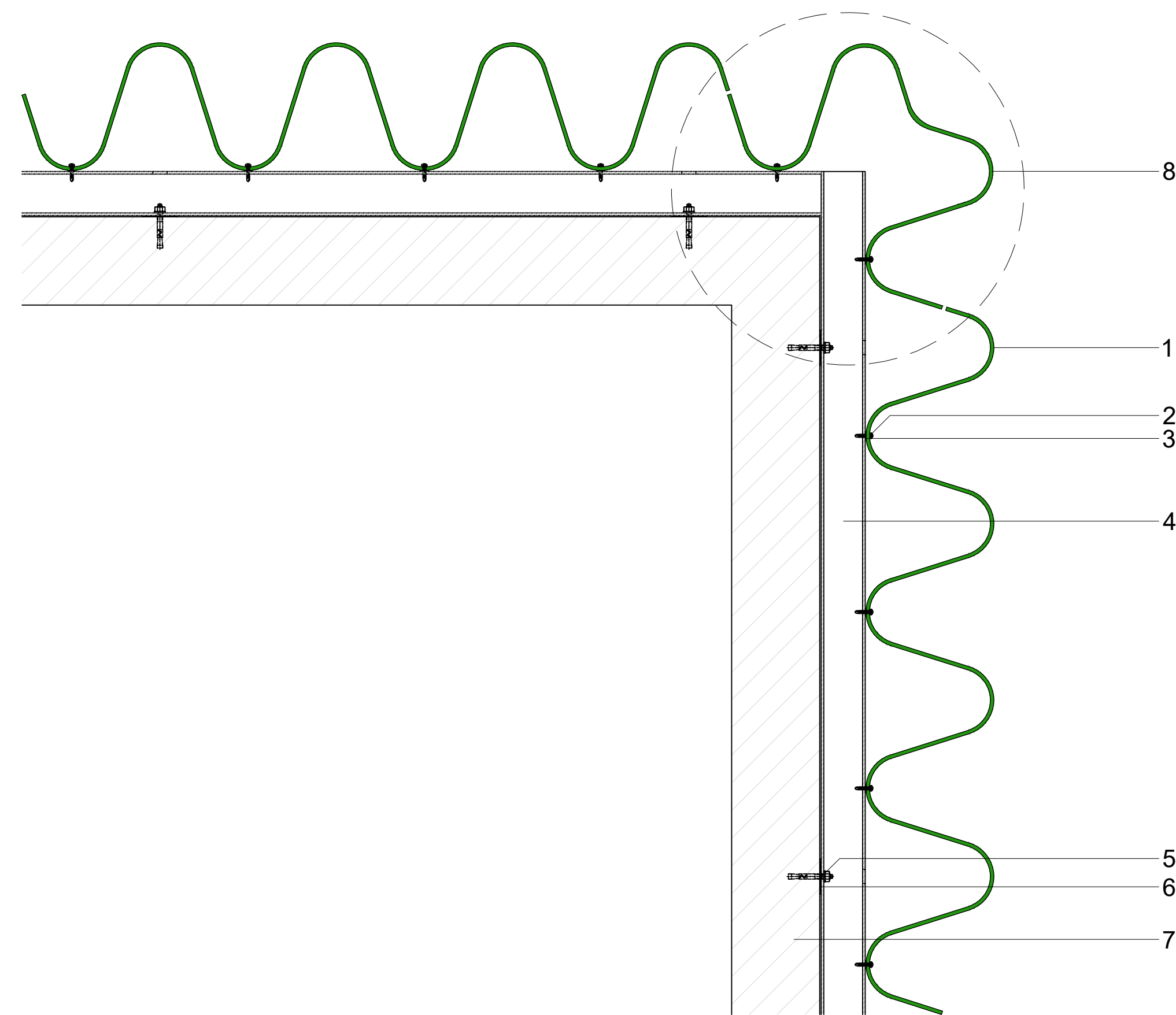

○ PMP U3-145 External Corner 90°  
1:1

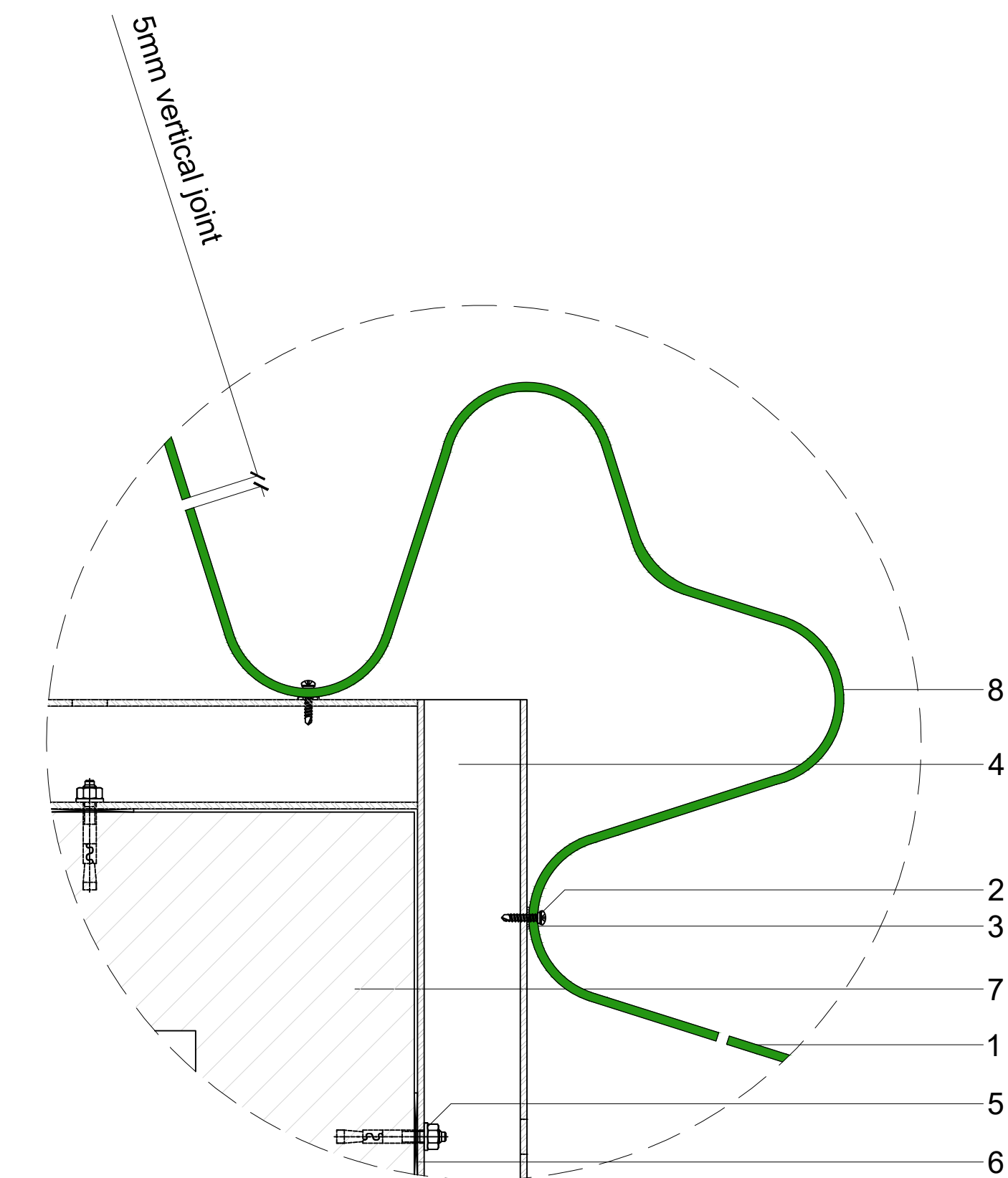

○ PMP U3-145 External Corner 90° Standard Detail  
1:2

NOTE:

All design related drawings and concepts are property of SOLIDAL®.  
Protected under Copyright Law.

PAGE:

2

DWG NAME:

SOLIDAL® PMP U3-145  
External Corner 90° Details

SCALE:

1:1 & 1:2 @ A1

DATE:

21 / JUN / 2023

**PMP**  
**SOLIDAL®**

SOLIDAL® PMP U3-145  
Perforated Metal Pressed  
Internal Corner 90° Detail

- 1 SOLIDAL® PMP T2® | T3® | T4®
- 2 S/S Metal Tek screw w/ EPDM Gasket
- 3 Isolation Barrier
- 4 Powder Coated RHS Support Frame
- 5 Anchor Bolt
- 6 Packing as required
- 7 Building Structure
- 8 SOLIDAL® PMP EC (External Corner) Module

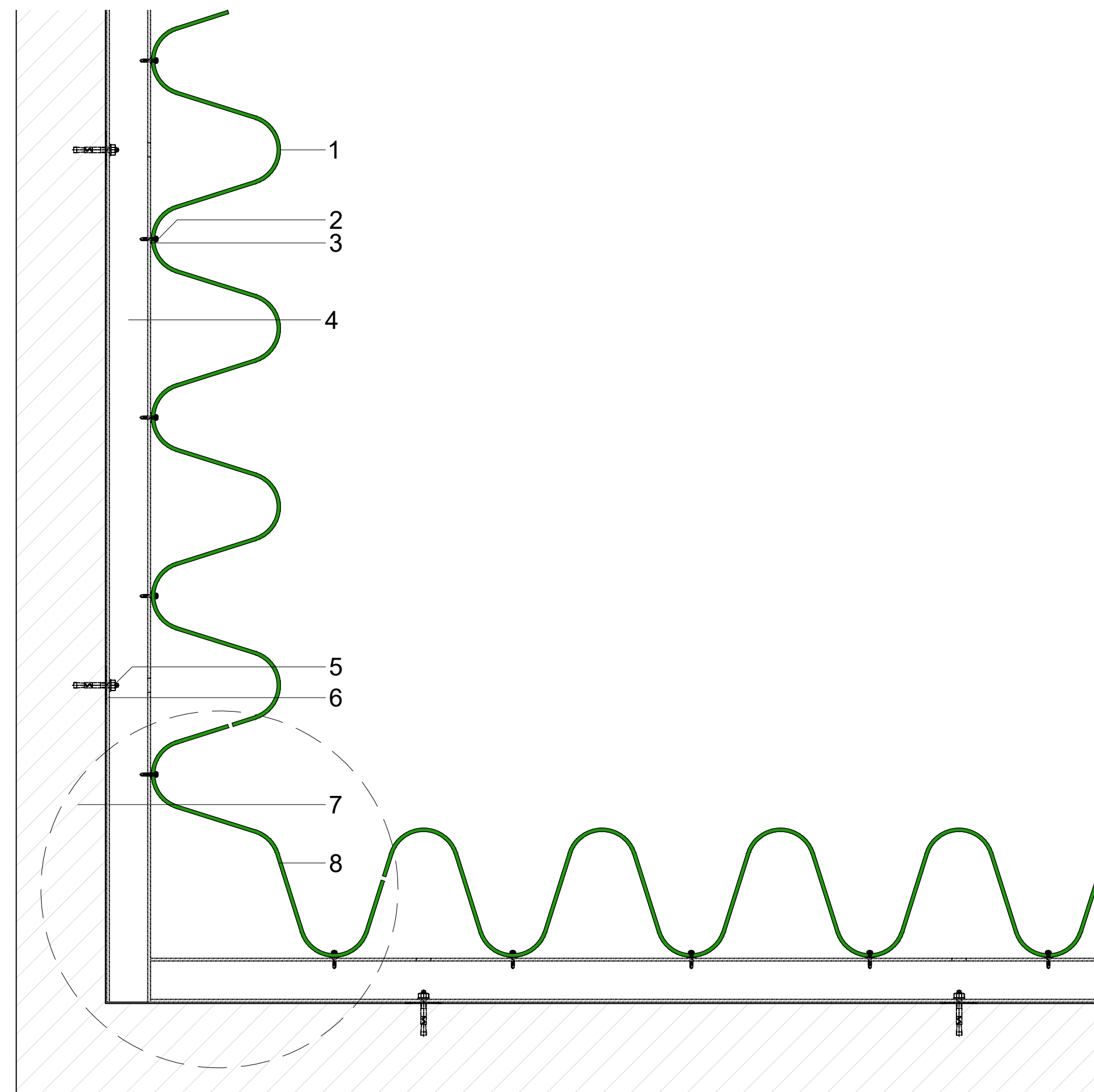

○ PMP U3-145 Internal Corner 90°  
1 : 1

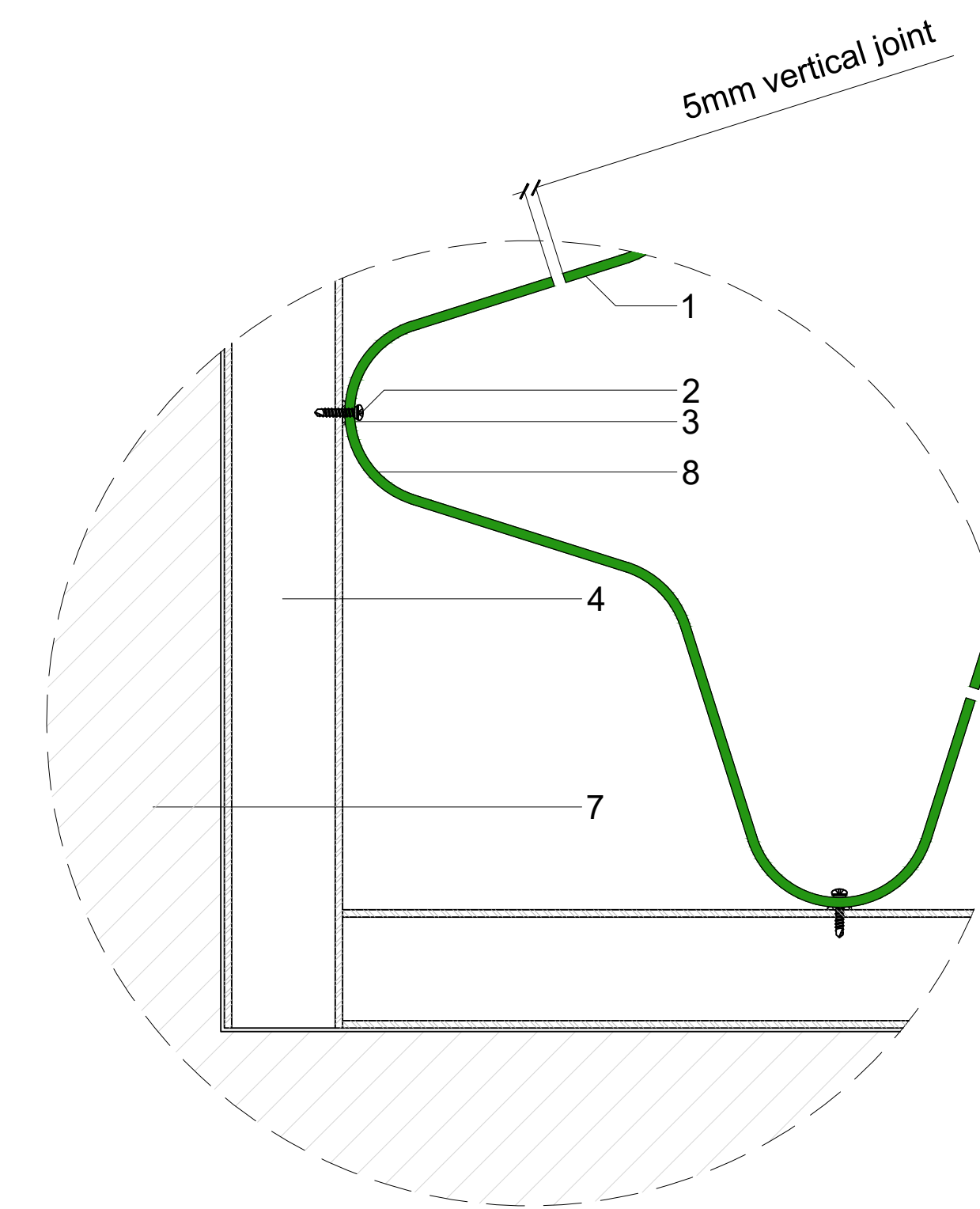

○ PMP U3-145 Internal Corner 90° Standard Detail  
1 : 2

NOTE:

All design related drawings and concepts are property of SOLIDAL®.  
Protected under Copyright Law.

PAGE:

3

DWG NAME:

SOLIDAL® PMP U3-145  
External Corner 90° Details

SCALE:

1:1 & 1:2 @ A1

DATE:

21 / JUN / 2023

**PMP**  
**SOLIDAL®**

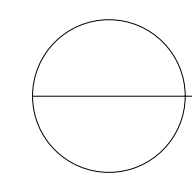
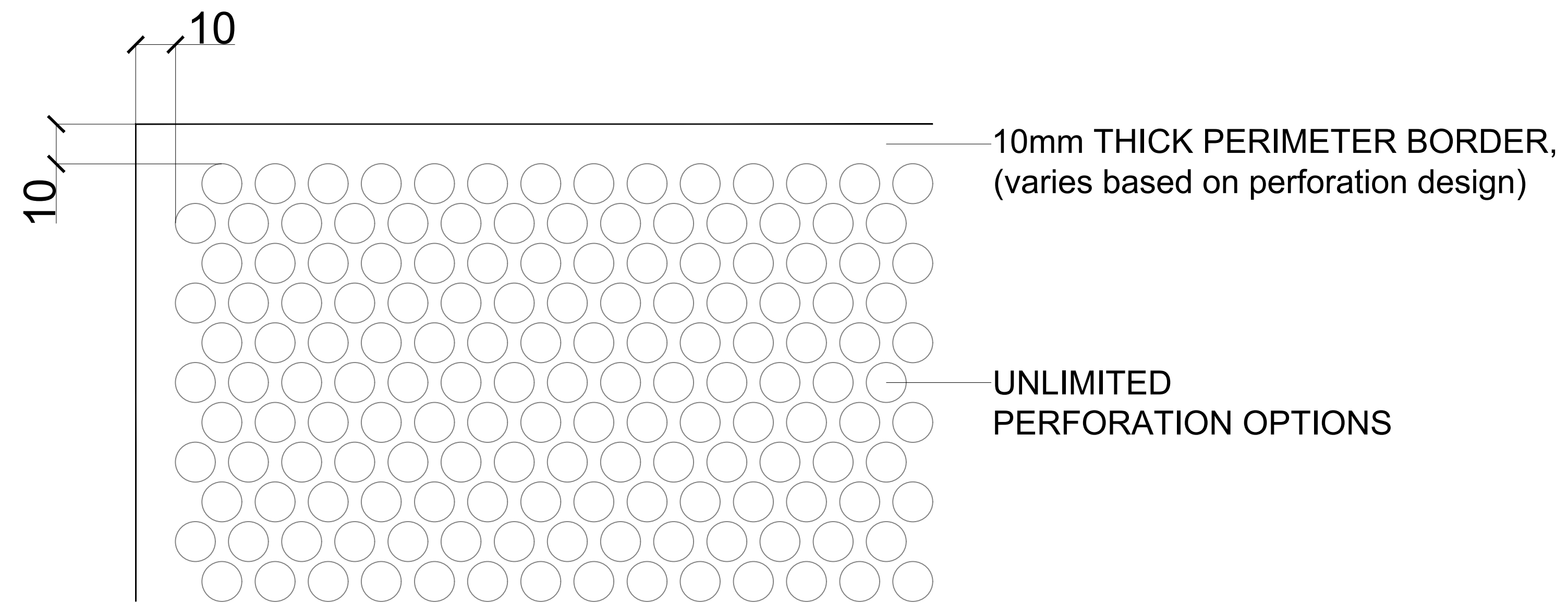

1:5

**MODULE PERFORATION  
BORDER DETAILS**

|  |                          |  |                                 |                               |
|--|--------------------------|--|---------------------------------|-------------------------------|
| <b>NOTE:</b><br>All design related drawings and concepts are property of SOLIDAL®.<br>Protected under Copyright Law. | <b>PAGE:</b><br><b>4</b> | <b>DWG NAME:</b><br>Module Perforation Details | <b>SCALE:</b><br>1:5 @ A1       | <b>PMP</b><br><b>SOLIDAL®</b> |
|  |                          |  | <b>DATE:</b><br>21 / JUN / 2023 |                               |

# SOLIDAL<sup>®</sup>

## HEAD OFFICE

10/450 Elizabeth Street,  
Surry Hills, Sydney,  
NSW, Australia 2010

1300 252 325  
info@solidal.com

solidal.com

### **DISCLAIMER:**

All design related drawings and concepts are property of SOLIDAL<sup>®</sup>.  
Protected under Copyright Law.

SOLIDAL<sup>®</sup> PMP<sup>®</sup> is designed as a rainscreen cladding system.

Separation barrier to be used between dissimilar metals.

For SOLIDAL<sup>®</sup> Custom PMP<sup>®</sup> Modules, please discuss with SOLIDAL<sup>®</sup> representative.



**SOLIDAL® PMP**  
Perforated Metal Pressed Screens  
**U3-185 Details**



**INDEX:**

---

**U3-185**

|                               |   |
|-------------------------------|---|
| U3-185 Vertical Joint Detail  | 1 |
| U3-185 External Corner Detail | 2 |
| U3-185 Internal Corner Detail | 3 |
| Module Perforation Detail     | 4 |

---

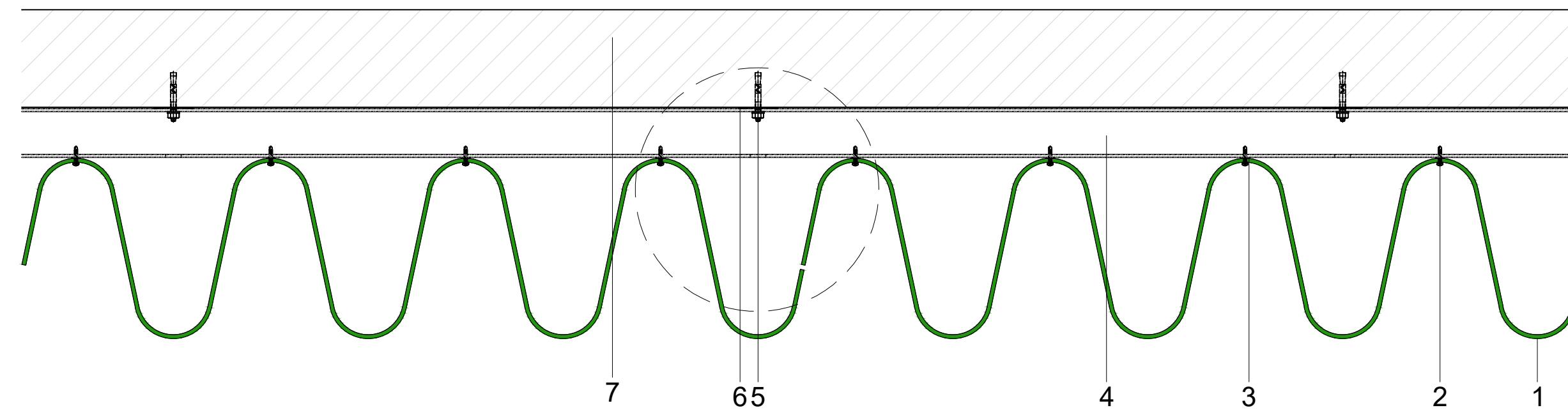

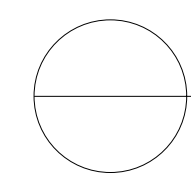
**PMP U3-185 Vertical Joint**  
 1:1

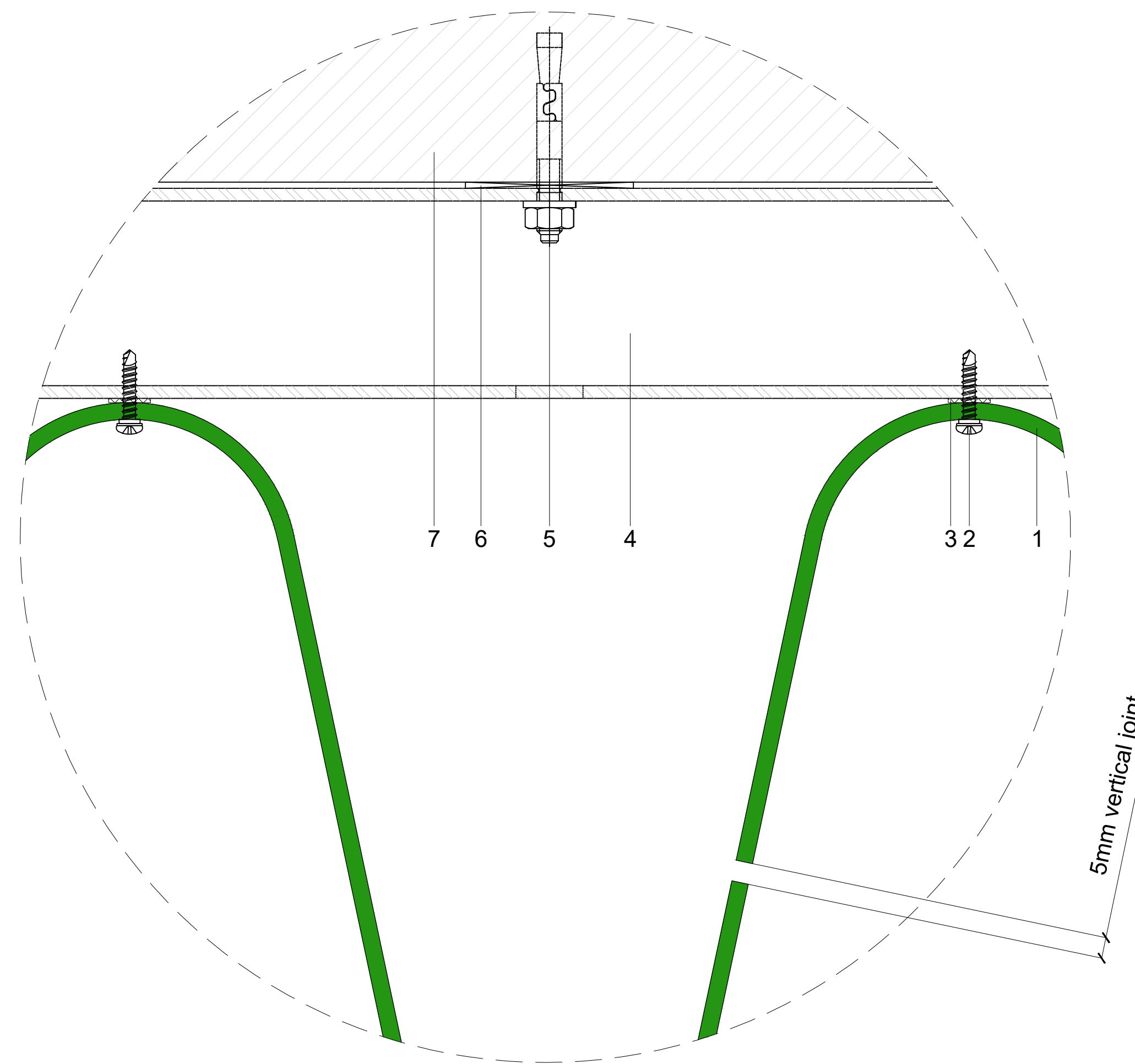

**SOLIDAL® PMP U3-185**  
 Perforated Metal Pressed  
 Vertical Joint - Typical Detail

- 1 SOLIDAL® PMP T2® | T3® | T4®
- 2 S/S Metal Tek screw w/ EPDM Gasket
- 3 Isolation Barrier
- 4 Powder Coated RHS Support Frame
- 5 Anchor Bolt
- 6 Packing as required
- 7 Building Structure

**PMP U3-185 Vertical Joint Detail**  
 1:5

|  |                          |  |                                 |                               |
|--|--------------------------|--|---------------------------------|-------------------------------|
| <b>NOTE:</b><br>All design related drawings and concepts are property of SOLIDAL®.<br>Protected under Copyright Law. | <b>PAGE:</b><br><b>1</b> | <b>DWG NAME:</b><br>SOLIDAL® PMP U3-185<br>Vertical Joint Detail | <b>SCALE:</b><br>1:1 & 1:5 @ A1 | <b>PMP</b><br><b>SOLIDAL®</b> |
|  |                          |  | <b>DATE:</b><br>21 / JUN / 2023 |                               |

**SOLIDAL® PMP U3-185**  
**Perforated Metal Pressed**  
**External Corner 90° Detail**

- 1 SOLIDAL® PMP T2® | T3® | T4®
- 2 S/S Metal Tek screw w/ EPDM Gasket
- 3 Isolation Barrier
- 4 Powder Coated RHS Support Frame
- 5 Anchor Bolt
- 6 Packing as required
- 7 Building Structure
- 8 SOLIDAL® PMP EC (External Corner) Module

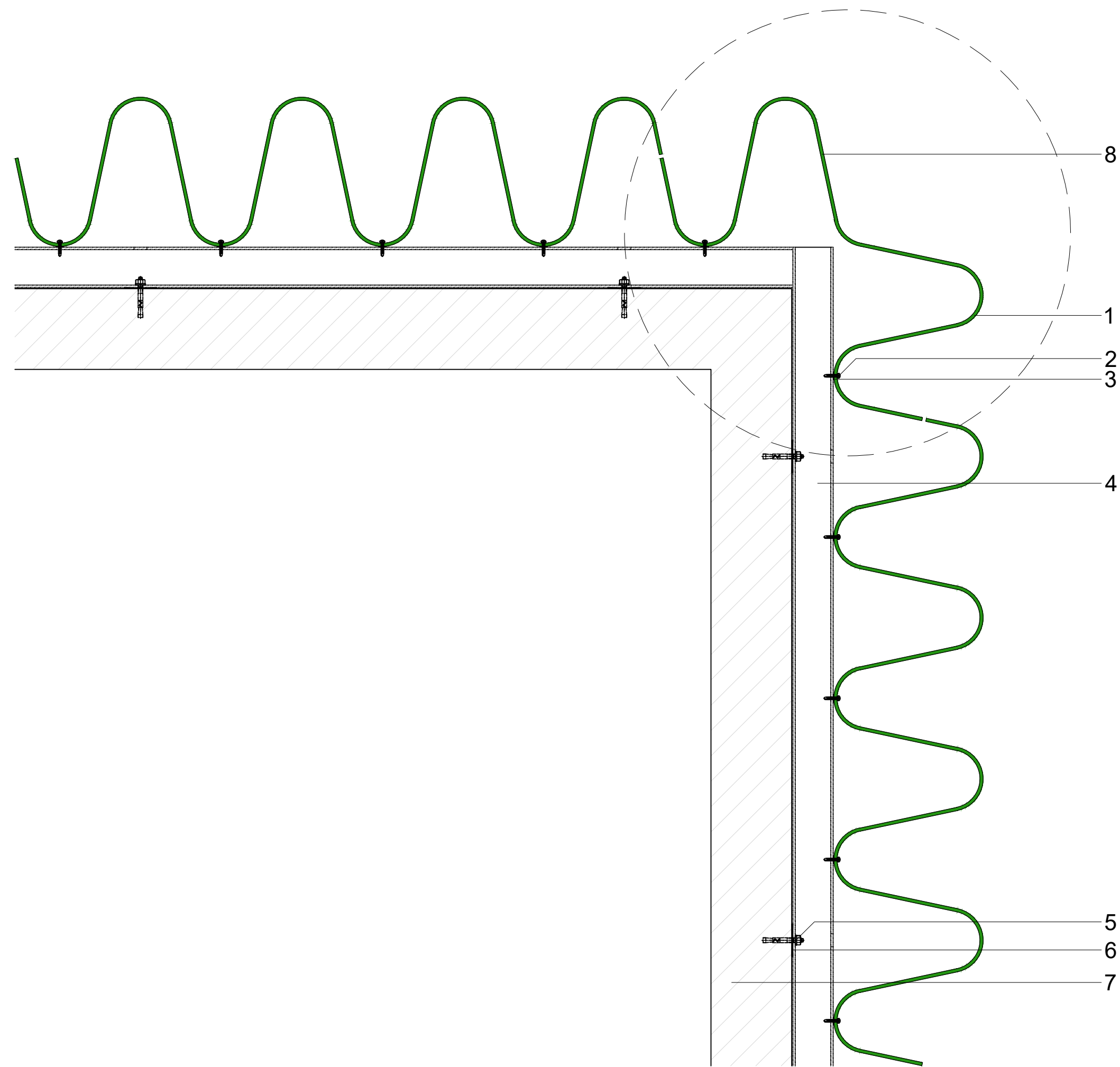

○ PMP U3-185 External Corner 90°  
 1:1

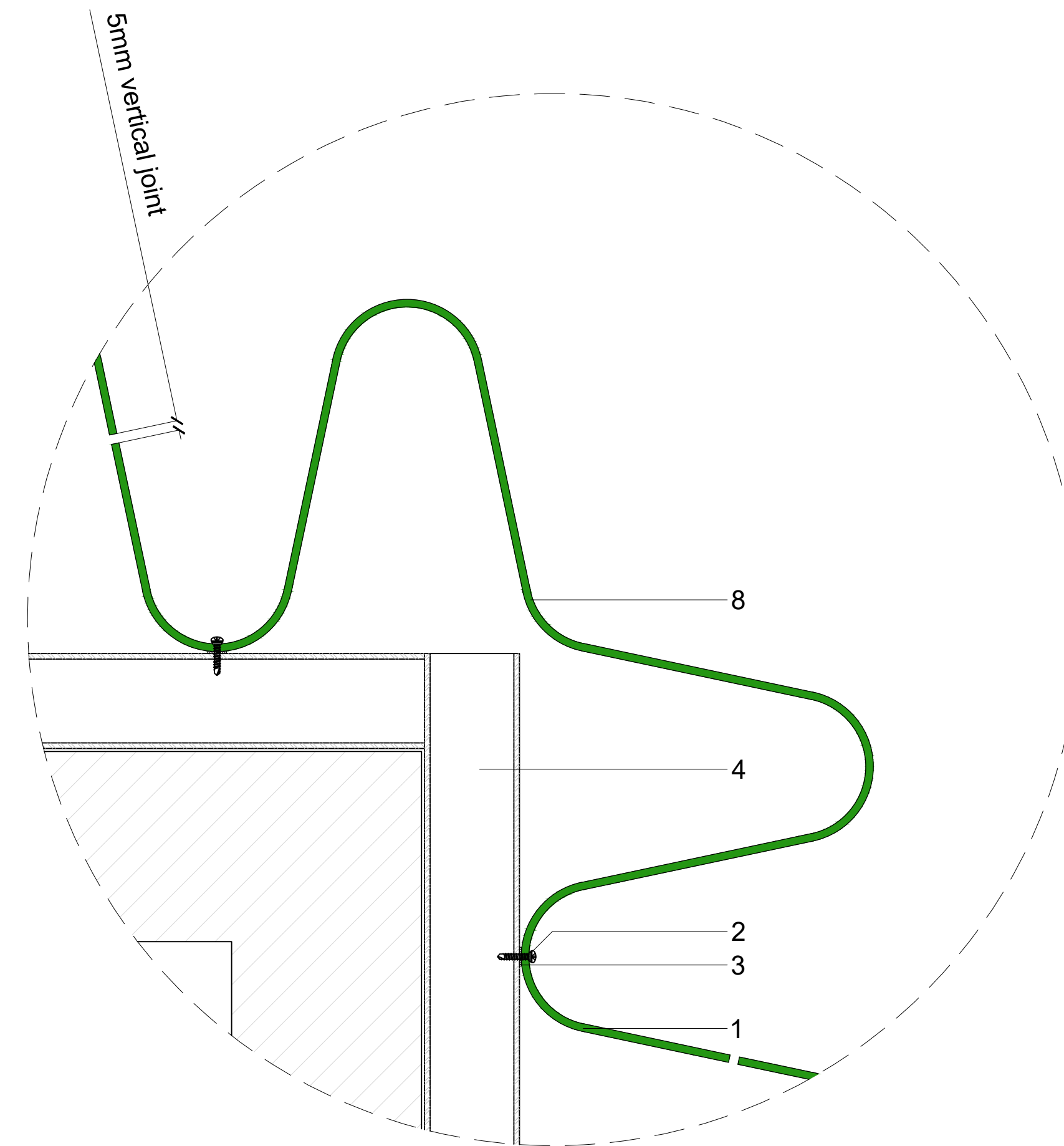

○ PMP U3-185 External Corner 90° Standard Detail  
 1:2

**NOTE:**  
 All design related drawings and concepts are property of SOLIDAL®.  
 Protected under Copyright Law.

**PAGE:**  
**2**

**DWG NAME:**  
 SOLIDAL® PMP U3-185  
 External Corner 90° Details

**SCALE:**  
 1:1 & 1:2 @ A1  
**DATE:**  
 21 / JUN / 2023

**PMP**  
**SOLIDAL®**

SOLIDAL® PMP U3-185  
Perforated Metal Pressed  
Internal Corner 90° Detail

- 1 SOLIDAL® PMP T2®|T3®|T4®
- 2 S/S Metal Tek screw w/ EPDM Gasket
- 3 Isolation Barrier
- 4 Powder Coated RHS Support Frame
- 5 Anchor Bolt
- 6 Packing as required
- 7 Building Structure
- 8 SOLIDAL® PMP EC (External Corner) Module

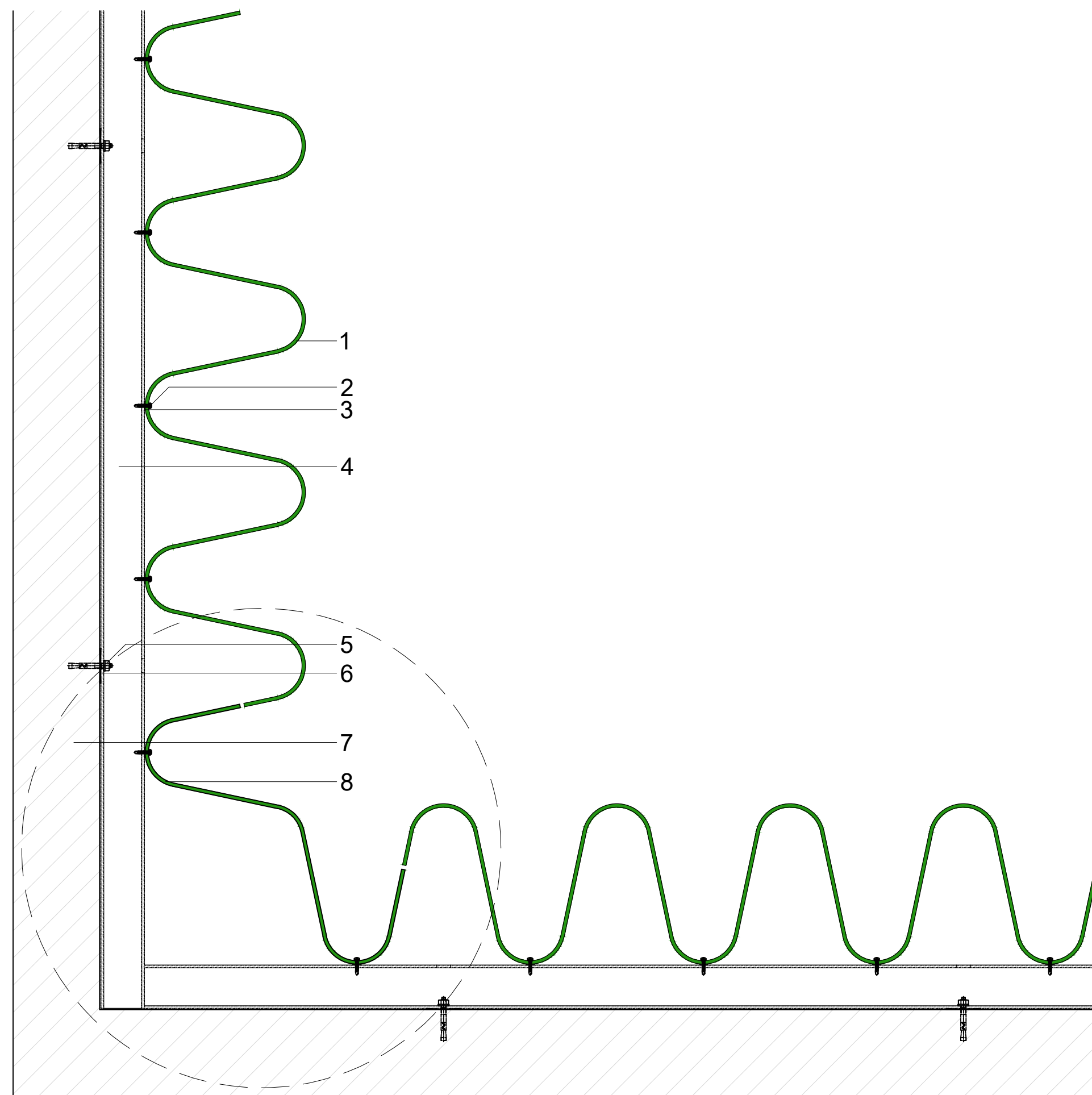

○ PMP U3-185 Internal Corner 90°  
1:1

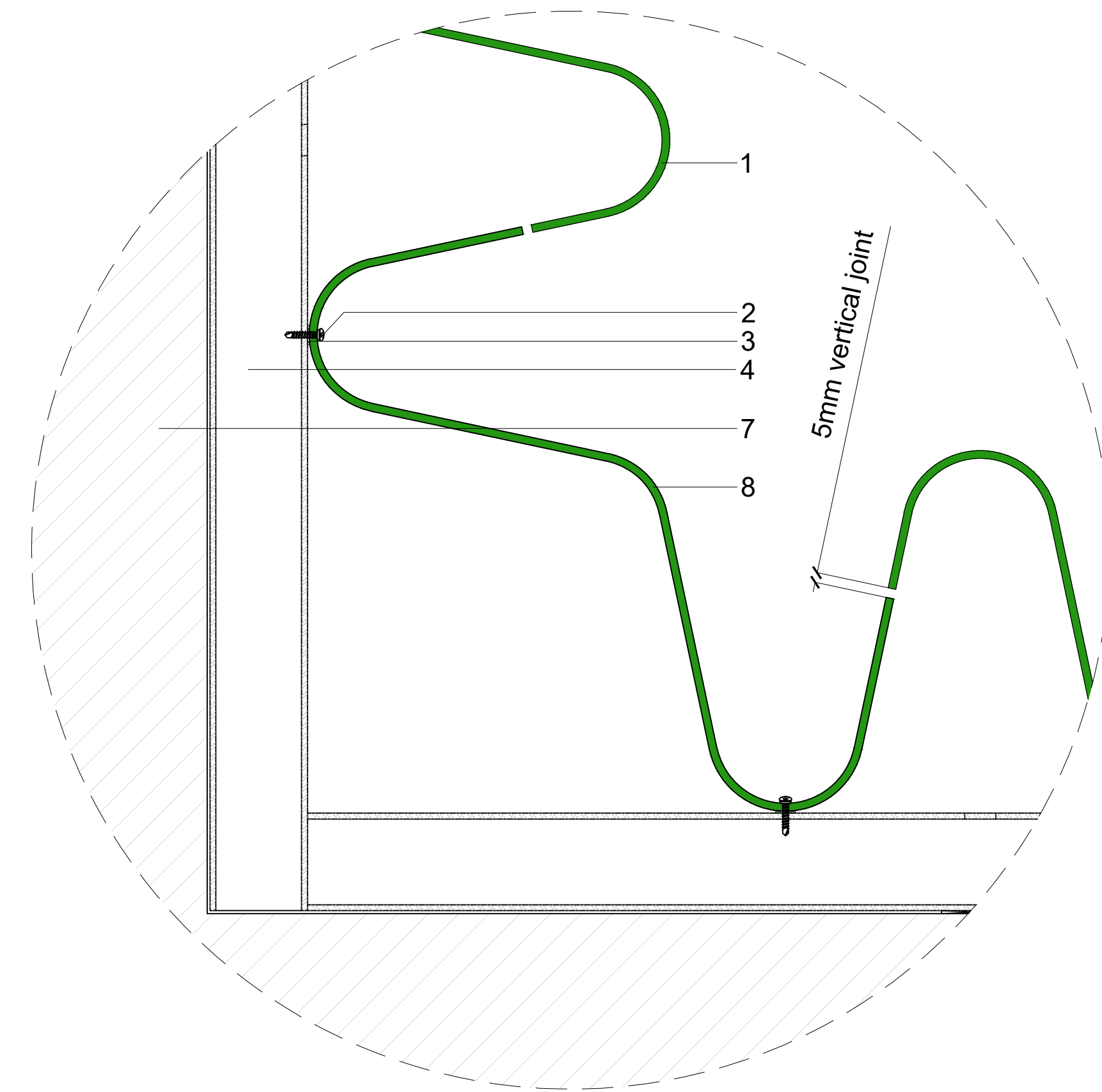

○ PMP U3-185 Internal Corner 90° Standard Detail  
1:2

NOTE:

All design related drawings and concepts are property of SOLIDAL®.  
Protected under Copyright Law.

PAGE:

3

DWG NAME:

SOLIDAL® PMP U3-185  
Internal Corner Details

SCALE:

1:1 & 1:2 @ A1

DATE:

21 / JUN / 2023

**PMP**  
**SOLIDAL®**

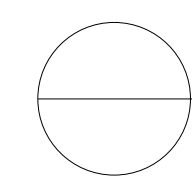
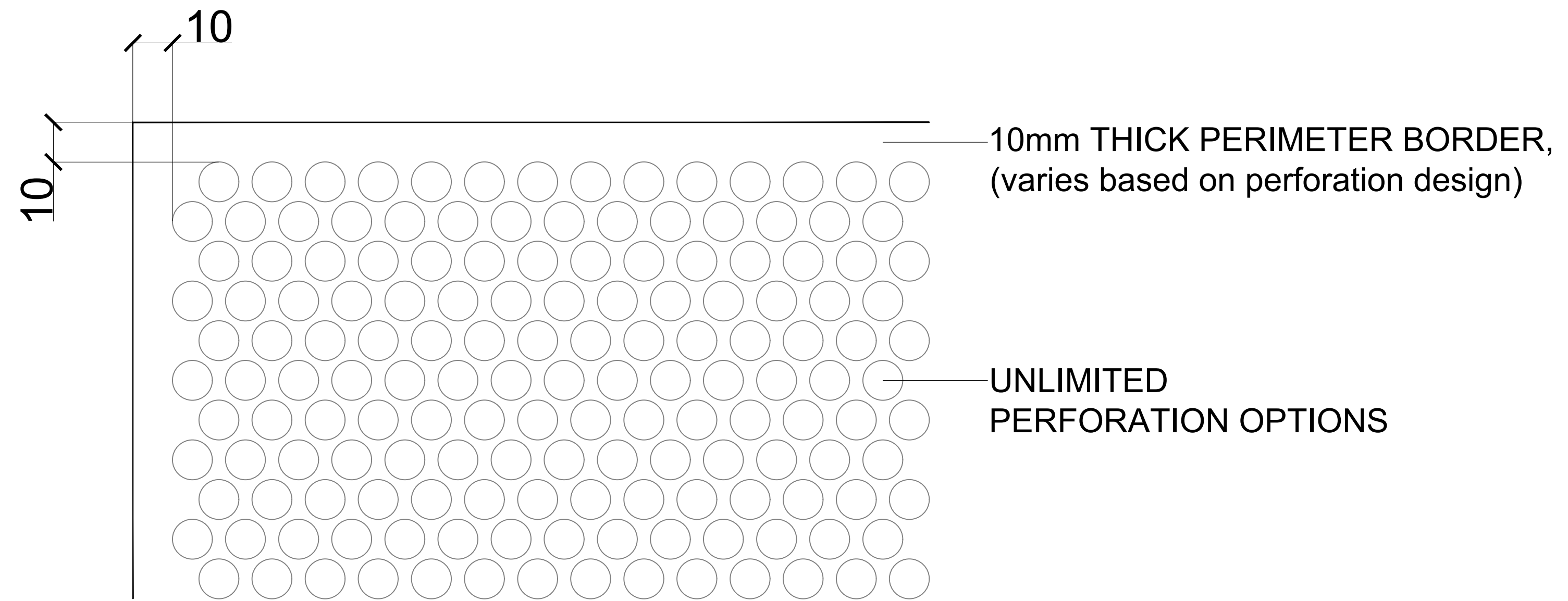

1:5

**MODULE PERFORATION  
BORDER DETAILS**

**NOTE:**

All design related drawings and concepts are property of SOLIDAL®.  
Protected under Copyright Law.

**PAGE:**

**4**

**DWG NAME:**

Module Perforation Details

**SCALE:**

1:5 @ A1

**DATE:**

21 / JUN / 2023

**PMP**

**SOLIDAL®**

# SOLIDAL<sup>®</sup>

## HEAD OFFICE

10/450 Elizabeth Street,  
Surry Hills, Sydney,  
NSW, Australia 2010

1300 252 325  
info@solidal.com

solidal.com

### **DISCLAIMER:**

All design related drawings and concepts are property of SOLIDAL<sup>®</sup>.  
Protected under Copyright Law.

SOLIDAL<sup>®</sup> PMP<sup>®</sup> is designed as a rainscreen cladding system.

Separation barrier to be used between dissimilar metals.

For SOLIDAL<sup>®</sup> Custom PMP<sup>®</sup> Modules, please discuss with SOLIDAL<sup>®</sup> representative.



**SOLIDAL® PMP**  
Perforated Metal Pressed Screens  
**U3-225 Details**

**INDEX:**

---

**U3-225**

|                               |   |
|-------------------------------|---|
| U3-225 Vertical Joint Detail  | 1 |
| U3-225 External Corner Detail | 2 |
| U3-225 Internal Corner Detail | 3 |
| Module Perforation Detail     | 4 |

---



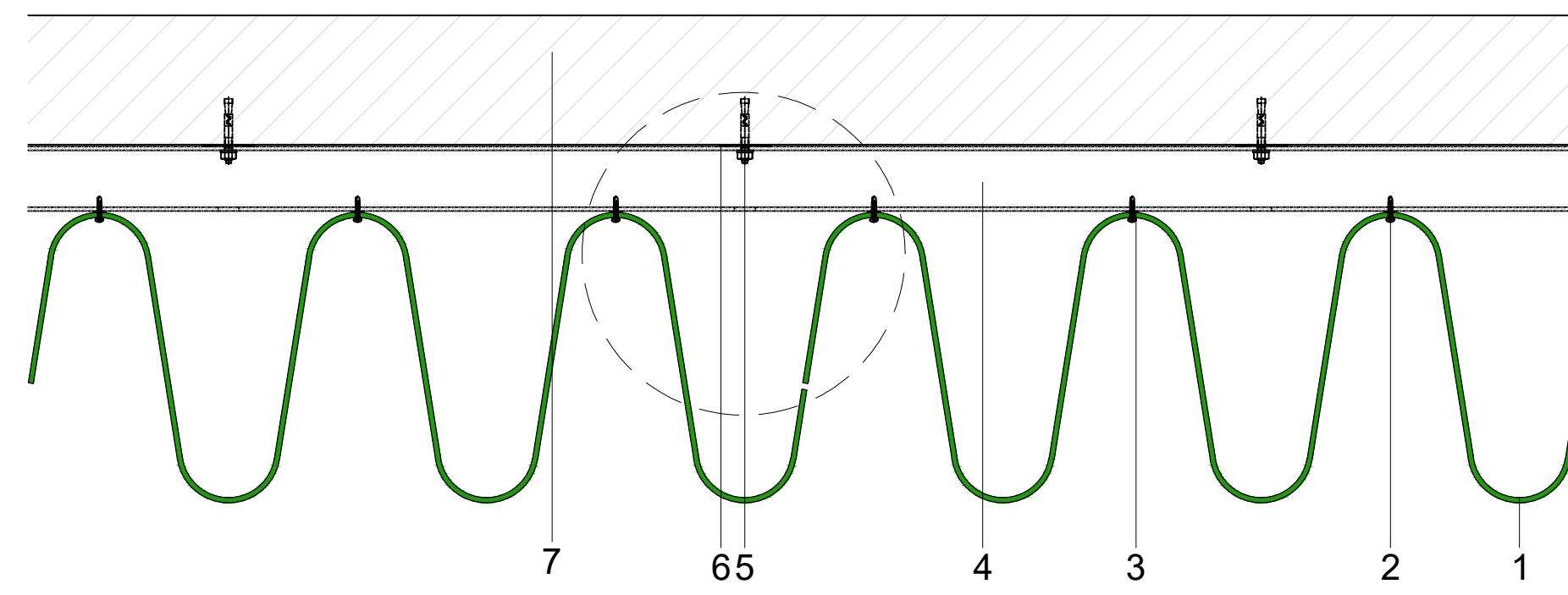

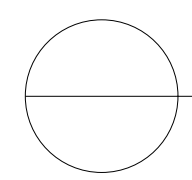
**PMP U3-225 Vertical Joint**  
 1:1

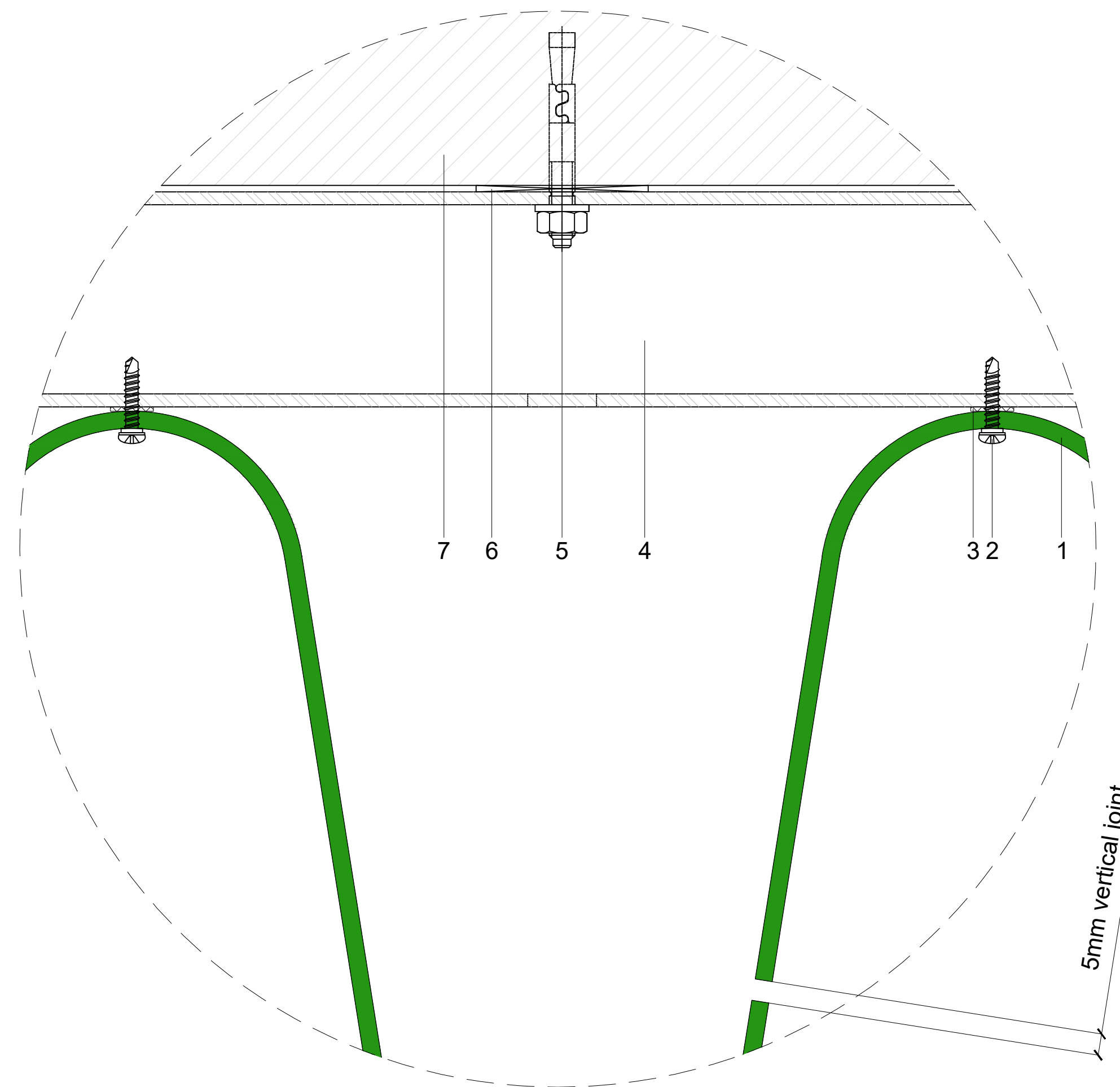

**SOLIDAL® PMP U3-225**  
 Perforated Metal Pressed  
 Vertical Joint - Typical Detail

- 1 SOLIDAL® PMP T2® | T3® | T4®
- 2 S/S Metal Tek screw w/ EPDM Gasket
- 3 Isolation Barrier
- 4 Powder Coated RHS Support Frame
- 5 Anchor Bolt
- 6 Packing as required
- 7 Building Structure

**PMP U3-225 Vertical Joint Detail**  
 1:5

|  |                          |  |                                 |                               |
|--|--------------------------|--|---------------------------------|-------------------------------|
| <b>NOTE:</b><br>All design related drawings and concepts are property of SOLIDAL®.<br>Protected under Copyright Law. | <b>PAGE:</b><br><b>1</b> | <b>DWG NAME:</b><br>SOLIDAL® PMP U3-225<br>Vertical Joint Detail | <b>SCALE:</b><br>1:1 & 1:5 @ A1 | <b>PMP</b><br><b>SOLIDAL®</b> |
|  |                          |  | <b>DATE:</b><br>21 / JUN / 2023 |                               |

SOLIDAL® PMP U3-225  
Perforated Metal Pressed  
External Corner 90° Detail

- 1 SOLIDAL® PMP T2® | T3® | T4®
- 2 S/S Metal Tek screw w/ EPDM Gasket
- 3 Isolation Barrier
- 4 Powder Coated RHS Support Frame
- 5 Anchor Bolt
- 6 Packing as required
- 7 Building Structure
- 8 SOLIDAL® PMP EC (External Corner) Module

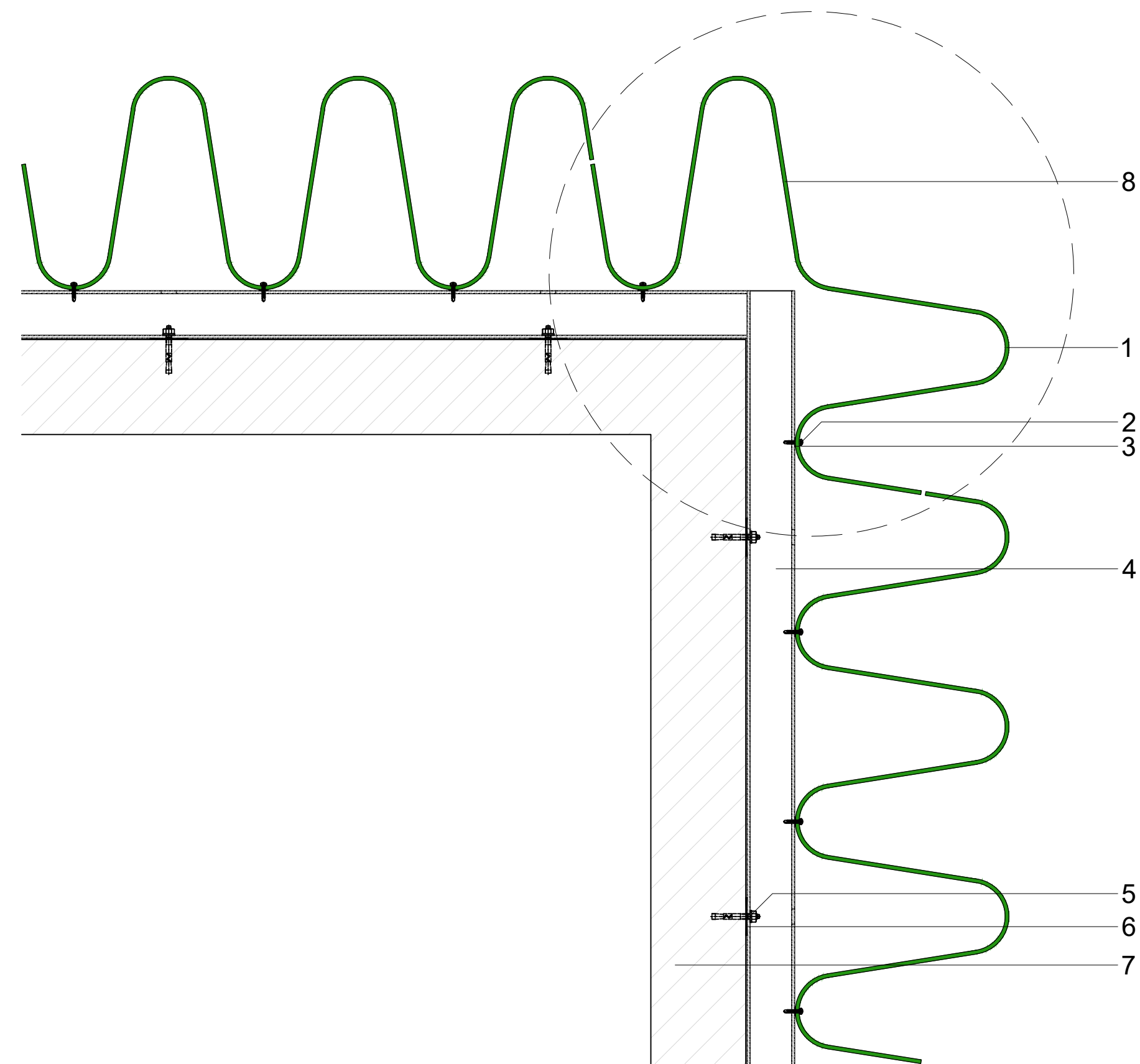

○ PMP U3-225 External Corner 90°  
1:1

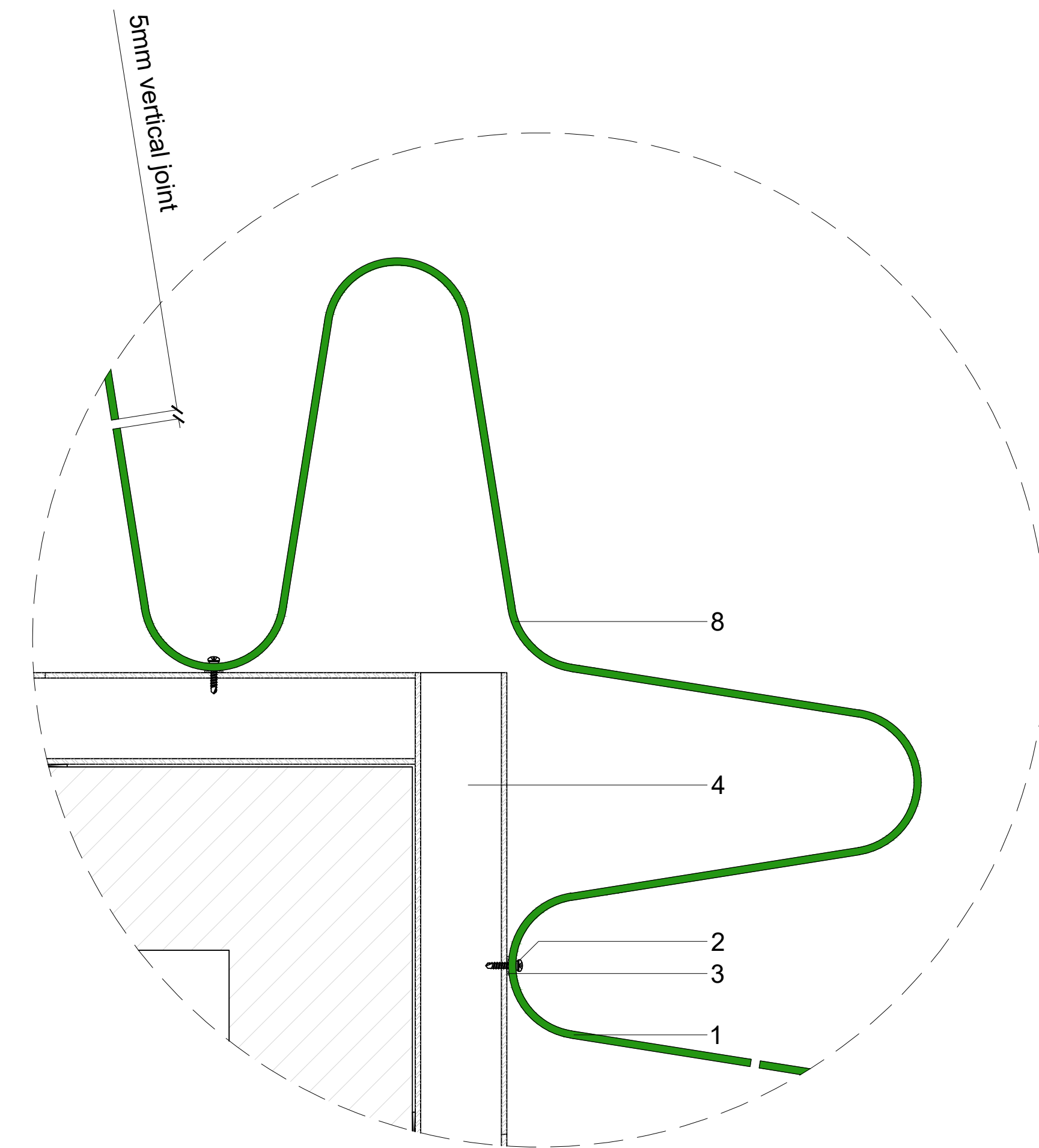

○ PMP U3-225 External Corner 90° Standard Detail  
1:2

NOTE:

All design related drawings and concepts are property of SOLIDAL®.  
Protected under Copyright Law.

PAGE:

2

DWG NAME:

SOLIDAL® PMP U3-225  
External Corner 90° Details

SCALE:

1:1 & 1:2 @ A1

DATE:

21 / JUN / 2023

**PMP**  
**SOLIDAL®**

SOLIDAL® PMP U3-225  
 Perforated Metal Pressed  
 Internal Corner 90° Detail

- 1 SOLIDAL® PMP T2®|T3®|T4®
- 2 S/S Metal Tek screw w/ EPDM Gasket
- 3 Isolation Barrier
- 4 Powder Coated RHS Support Frame
- 5 Anchor Bolt
- 6 Packing as required
- 7 Building Structure
- 8 SOLIDAL® PMP EC (External Corner) Module

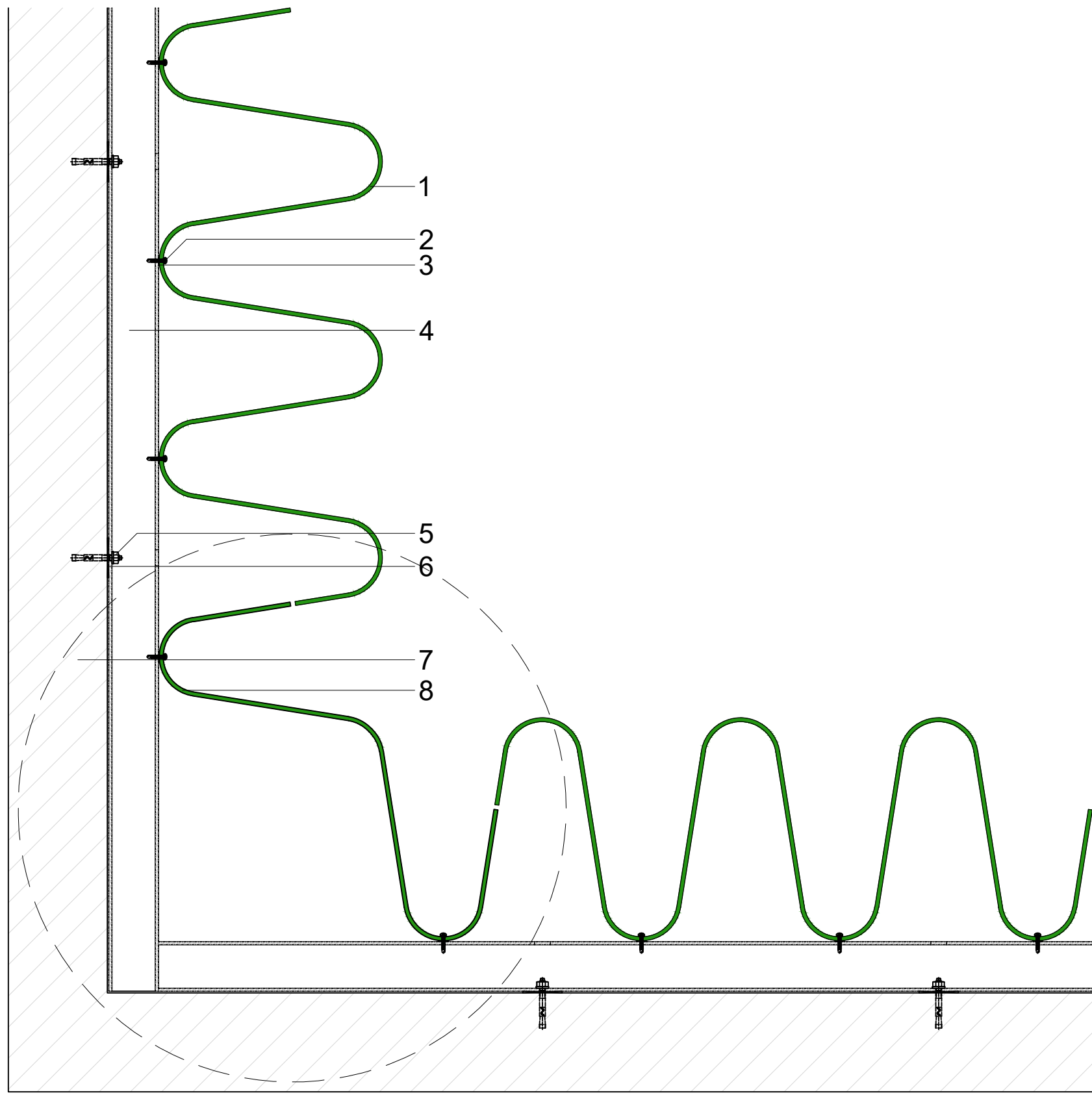

○ PMP U3-225 Internal Corner 90°  
 1:1

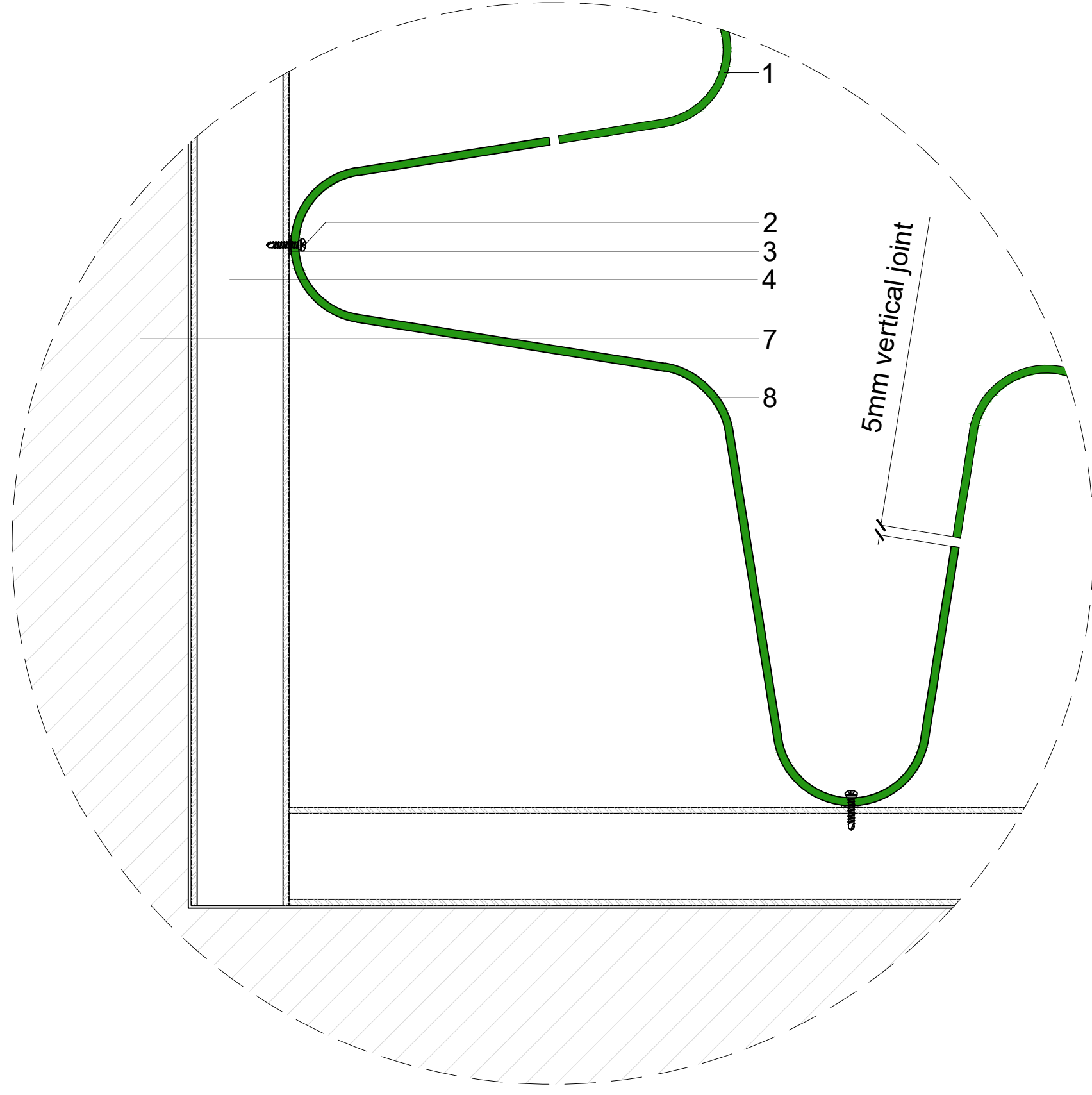

○ PMP U3-225 Internal Corner 90° Standard Detail  
 1:2

**NOTE:**  
 All design related drawings and concepts are property of SOLIDAL®.  
 Protected under Copyright Law.

**PAGE:**  
**3**

**DWG NAME:**  
 SOLIDAL® PMP U3-225  
 Internal Corner Details

**SCALE:**  
 1:1 & 1:2 @ A1  
**DATE:**  
 21 / JUN / 2023

**PMP**  
**SOLIDAL®**

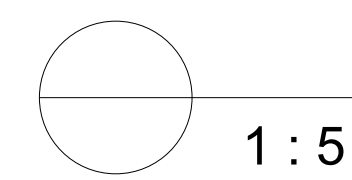
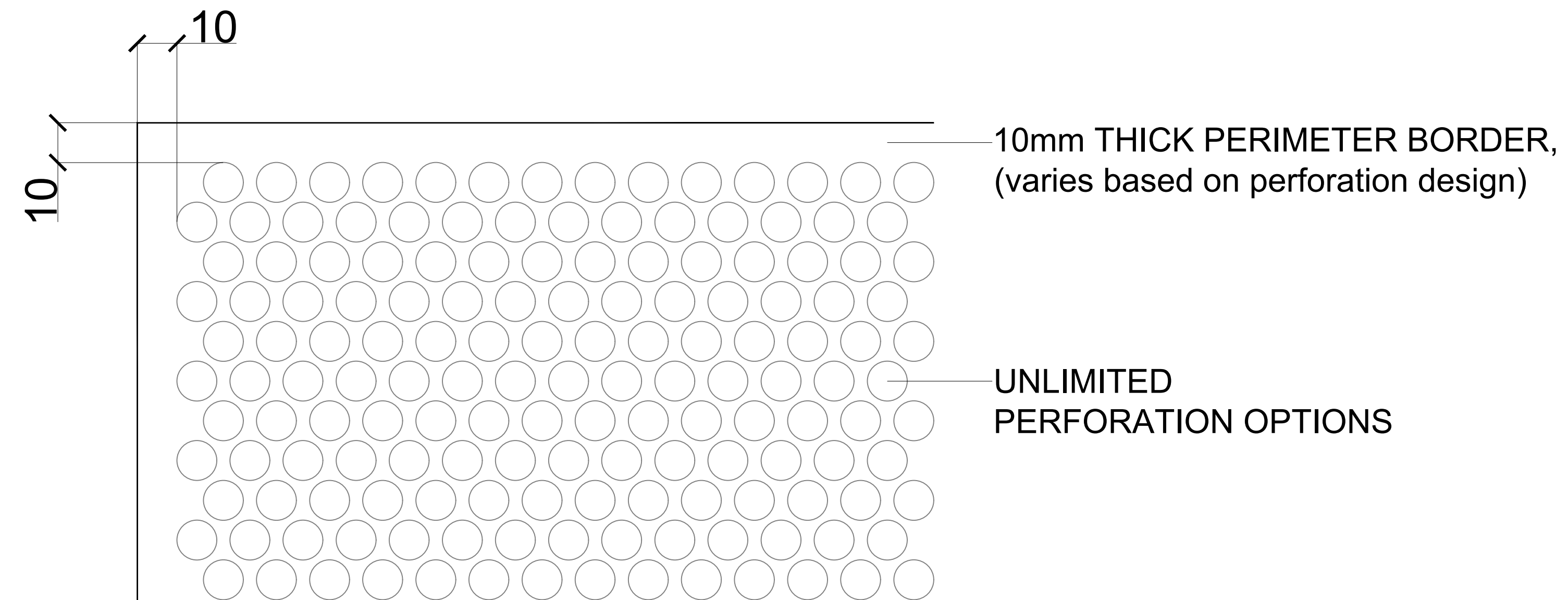

1:5  
**MODULE PERFORATION  
 BORDER DETAILS**

|  |   |  |                                 |                                   |
|--|---|--|---------------------------------|-----------------------------------|
| <b>NOTE:</b><br>All design related drawings and concepts are property of SOLIDAL®.<br>Protected under Copyright Law. | <b>PAGE:</b><br><div style="font-size: 2em; font-weight: bold; text-align: center;">4</div> | <b>DWG NAME:</b><br>Module Perforation Details | <b>SCALE:</b><br>1:5 @ A1       | <b>PMP</b><br><br><b>SOLIDAL®</b> |
|  |   |  | <b>DATE:</b><br>21 / JUN / 2023 |                                   |

# SOLIDAL<sup>®</sup>

## HEAD OFFICE

10/450 Elizabeth Street,  
Surry Hills, Sydney,  
NSW, Australia 2010

1300 252 325  
info@solidal.com

solidal.com

### **DISCLAIMER:**

All design related drawings and concepts are property of SOLIDAL<sup>®</sup>.  
Protected under Copyright Law.

SOLIDAL<sup>®</sup> PMP<sup>®</sup> is designed as a rainscreen cladding system.

Separation barrier to be used between dissimilar metals.

For SOLIDAL<sup>®</sup> Custom PMP<sup>®</sup> Modules, please discuss with SOLIDAL<sup>®</sup> representative.