

# TEGO® BOX

<b>Model</b>	TEGO® <b>BOX</b>
<b>Product Code</b>	TEGO® <b>B20   B60   B90   B120</b>
<b>Thickness</b>	T3® (3mm) (8.1 kg/m <sup>2</sup> )
<b>TEGO® Module Stiffeners</b>	Mechanically Fixed
<b>Joint Type</b>	Dry Joint (Rainscreen)
<b>Joint Width</b>	12-15mm (Custom)
<b>Finish Options</b>	Powder Coat (Akzonobel Interpon / Dulux Duratec, Fluoraset) or PVDF Wet Spray (P.P.G) in unlimited colours. (Colour matching available)

**Protect your Spec. & your Environment**

Recommended for architectural specification:  
**SOLIDAL® Post Applied Paint, Mechanically Fixed Stiffeners, Smartwelded Corners.**  
 100% Recyclable (No combustible Glues or Tapes used)

Depth (D) mm	Width (W) mm	Length (L) mm
20, 60, 90, 120	600, 900, 1200	900, 1200, 3000, 4000

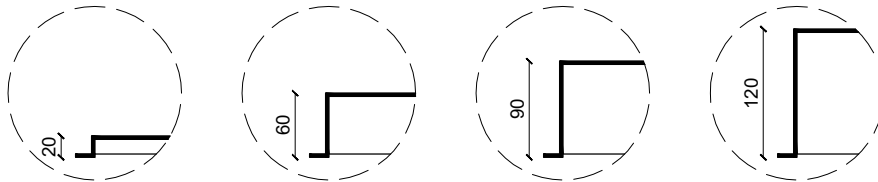
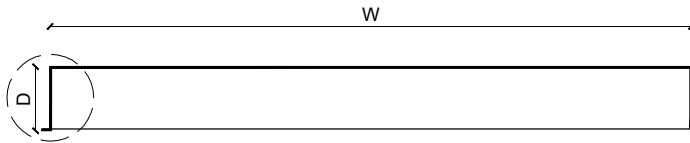

TEGO® PRODUCT CODE      TEGO® **B20**      TEGO® **B60**      TEGO® **B90**      TEGO® **B120**

**Applications:**

Cladding | Facades | All Building Envelopes

**Attachment Methods:**

Mechanically fixed through perimeter SOLIDAL® folded flange into subframe. (Cleave system optional)

**TEGO® MODULE SIZE**

