

Insulated Panels
Australia

Eurobond Firemaster Extra Wall Panel Product Data Sheet

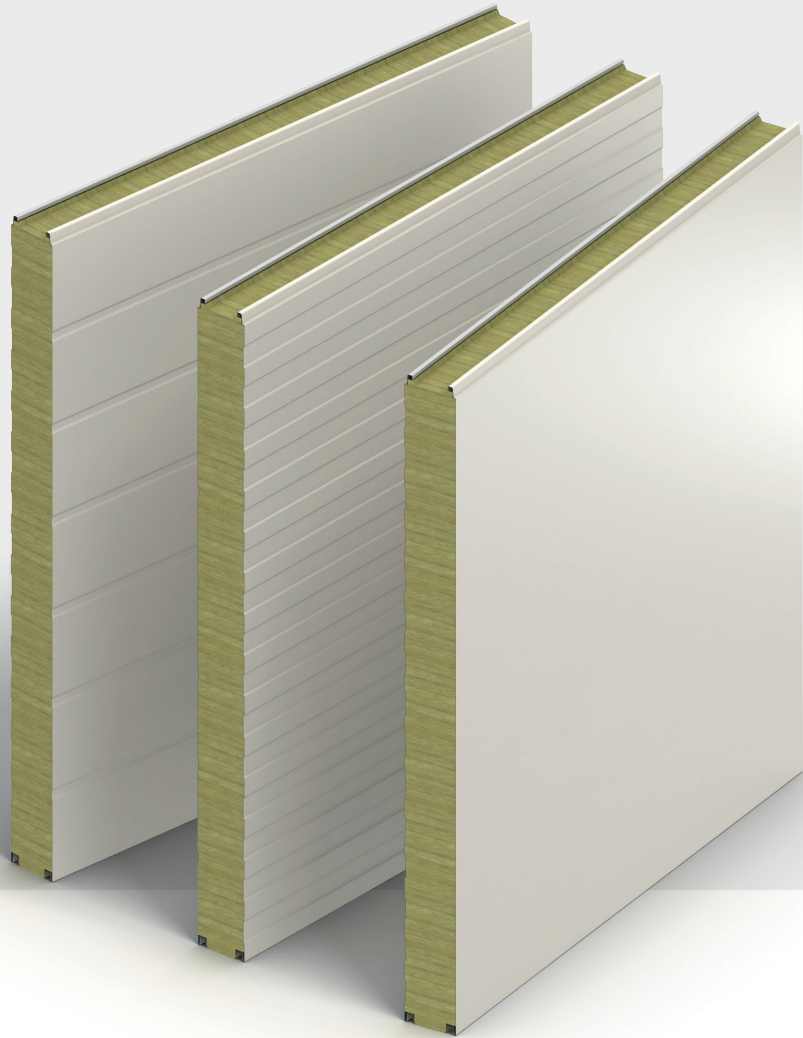

Product Data

Product Overview

Firemaster Extra Wall Panel is an internal wall solution that is ideally suited for non-load bearing internal partition walls. All Firemaster panels are manufactured with a stone wool core that provides built-in passive fire protection, structural strength and robustness. The panels are available in a wide range of finishes, including a foodsafe coating, providing a smooth, anti-static internal surface.

Application

Eurobond Firemaster Extra Wall Panels are ideally suited for the construction of non-load bearing internal partition walls with fire resistance performance requirements. This panel system is ideal for use in food processing and storage applications, along with data centres, microelectronics and pharmaceutical facilities, where protected zones or clean rooms are often required.

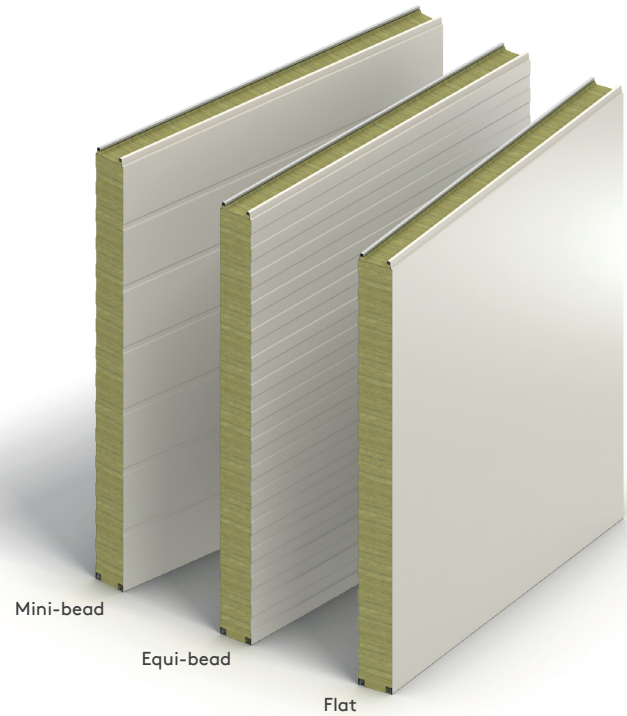

Dimensions, Thermal Performance & Weight

Panel Nominal Thickness (mm)	Product R-Value (m ² K/W) at 23°C	Total R-Value (m ² K/W)		Weight* (kg/m ²)
		Heat Flow Out (Winter)	Heat Flow In (Summer)	
75	1.52	1.76	1.61	17.5
100	2.04	2.31	2.11	20.5
125	2.57	2.87	2.62	23.5
150	3.10	3.43	3.13	26.5
175	3.65	4.01	3.65	29.5
200	4.17	4.55	4.14	32.5
240	5.02	5.45	4.95	37.3
300	6.29	6.79	6.17	42.0

Declared Product R-Value is calculated in accordance with AS/NZS 4859.1: 2018 as required for compliance to the National Construction Code.

The R-Values shown above are the total R-Values for the building element as required by the Energy Provisions of the National Construction Code, calculated in accordance with AS/NZS 4859.2: 2018. Eurobond Firemaster Extra Wall Panels are manufactured, tested and packaged in conformance with AS/NZS 4859.1: 2018.

* Actual weight subject to vary ±10% due to manufacturing and raw material tolerances.

Available Lengths

Standard lengths	1.8m - 11.8m
------------------	--------------

Cover Width

Standard cover width	1100 mm
----------------------	---------

Fixing Method

Through-fix.

Product Tolerances

Length	± 10 mm
Cover Width	± 2 mm
Thickness	± 2 mm
Facing Squareness	± 2 mm
Corners (Leg Length)	± 3 mm
Flatness	1.5 mm from the theoretical flat plane over a distance of 700 mm
Joint Gap	± 2 mm

Profiles

External Profiles: Flat, Mini-bead or Equi-bead.

Internal Liner: Mini-bead or Equi-bead.

Flat / Mini-bead

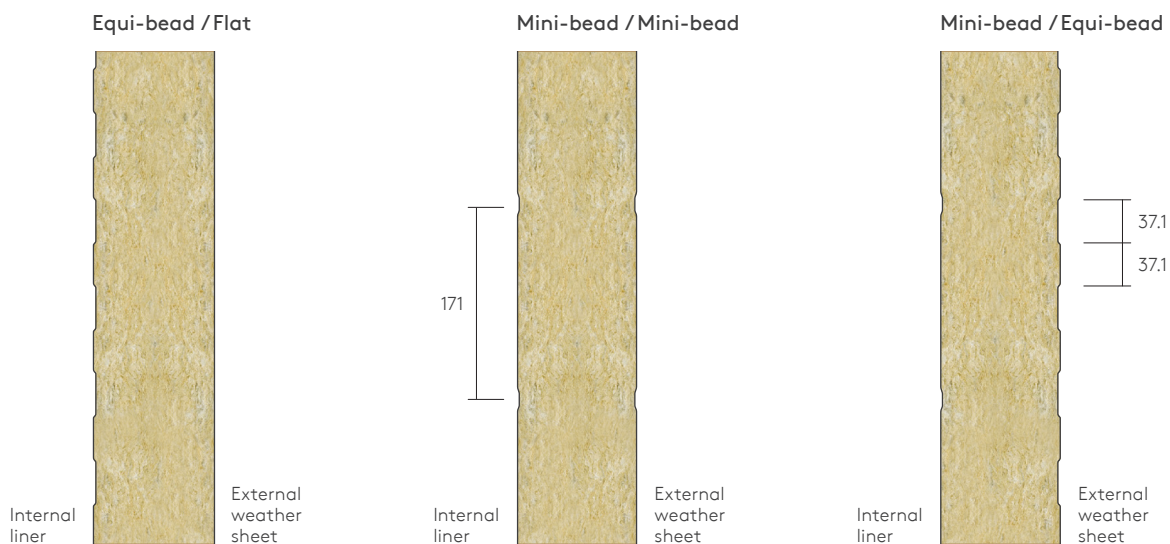
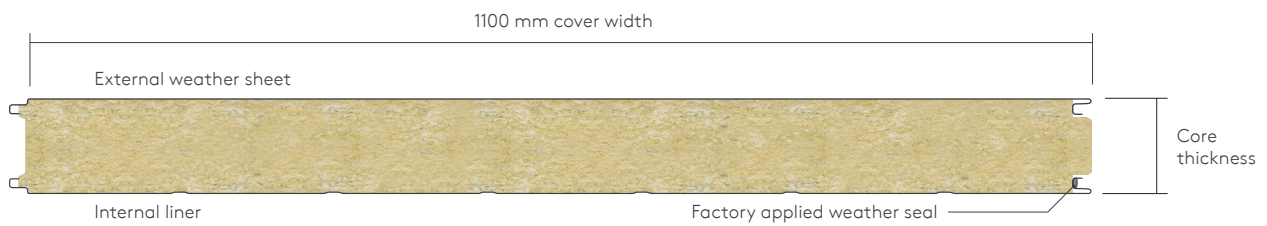

Note: Dimensions are nominal. Actual dimensions will vary due to manufacturing tolerances. Precise dimensions must always be measured from actual samples. All measurements in mm.

Insulation Core

Eurobond Firemaster Extra Wall Panels are manufactured with a 115 kg/m³ non-combustible stone wool core which is specifically designed to be used in insulated panels where excellent thermal and fire resistance properties are required.

Structural Performance

Please contact Technical Services for project specific support on the spanning performance of Eurobond Firemaster Extra Wall Panels.

Panel Joint

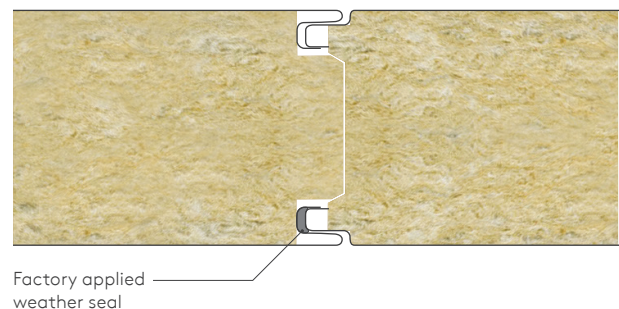

Product Data

Certification and Testing

Fire Performance

Reaction to Fire

Eurobond Firemaster Extra Wall Panels are Deemed to Satisfy (DTS) non-combustible under provision C1.9 (e) (Vii) of the National Construction Code.

Product	Test Method	Result
Eurobond stonewool	AS 1530.1 1994 (2016) - Combustibility test for materials	Not deemed combustible
Eurobond panel skin (uncoated)		Not deemed combustible

Test	Test Method	Result
Ignitability	AS/NZS: 1530.3: 1999	Ignitability Index: 0
Flame Spread		Spread of Flame Index: 0
Heat Release		Heat Evolved Index: 0
Smoke Release		Smoke Developed Index: 2

Fire Resistance

Eurobond Firemaster Extra Wall Panels are tested to provide up to a 2-hours fire resistance level when assessed in accordance with AS 1530.4.

Fire resistance levels are subject to panel thickness, width, orientation, distance between supports and method of assembly. Please contact Technical Services for the specific installation detail required.

Insurer Approvals

Eurobond Firemaster Extra Wall Panels are tested to:

- FM 4880 approval standard for Class 1 fire rating of building panels or interior finish materials, unlimited height for thicknesses 75 mm to 240 mm and panel width of 1100 mm.
- FM 4882 approval standard for Class 1 interior wall and ceiling materials or systems for smoke sensitive occupancies, unlimited height for thicknesses 75 mm to 150 mm and panel width of 1100 mm.

FM approvals are subject to the following certified names:

- Firemaster Wall Extra

Insurer approvals are large scale testing regimes that provide objective third-party testing, which is underpinned by quarterly, half-yearly and yearly factory surveillance audits (depending on the region) to verify compliance. Insurer approvals are subject to panel thickness, width, orientation, method of assembly, steel coating and manufacturing facility. Please contact Technical Services for project specific details.



Acoustic Performance

Core Thickness (mm)	75	100	125	150	175	200	240	300
SRI (dB)	31	33	33	34	35	36	36	36

For specific acoustic information contact Technical Services.

Materials

- Metallic coated steel in accordance with EN 10326.

Coatings

Standard coating offering:

Colorcoat® PE25

Colorcoat® PE25 is a smooth 25 micron RAL 9010 polyester coated facing, suitable for applications requiring a straightforward finish.

The pre-finished steel is a product suitable for undemanding wall and ceiling applications particularly in non-aggressive environments such as data centres, offices, schools, hospitals, hotels and residential sectors.

Coating offering available on request:

Advantica® L Control

Advantica® L Control is a proven and highly durable pre-finished steel for use in demanding controlled environments such as food processing and packing, clean rooms, hygienic and other amenities. It has a PVC outer layer developed by Tata Steel in conjunction with leading film manufacturers.

- Food safe – meeting stringent requirements for continuous food contact
- Highly resistant to staining
- Excellent corrosion resistance
- Anti-static – reducing the attraction of dust and dirt

*Please contact Technical Services for further information regarding substrates and coatings. Internal coatings subject to availability and panel cover width.

Quality and Durability

Eurobond Firemaster Extra Wall Panels are manufactured from high quality materials using state-of-the-art production equipment to rigorous quality control standards, complying with ISO 9001 standard, ensuring long-term reliability and service life. The panels are also being manufactured under Environmental Management System Certification ISO 14001 and Occupational Health and Safety Certification ISO 45001.

Packaging

Eurobond Firemaster Extra Wall Panels are stacked horizontally. The entire length of the pack of panels is shrink wrapped. The number of panels in each pack depends on panel length, weight, and thickness. Typical pack height is 1200 mm. Additional corner and edge protection for container transport is offered upon request.

Delivery

All deliveries (unless indicated otherwise) are by flatbed road transport to project site. Offloading is the responsibility of the client.

Contact Details

Australia

Kingspan Insulated Panels Pty Ltd
38-52 Dunheved Circuit | St Marys
NSW 2760 | Australia

T: +61 (02) 8889 3000

F: +61 (02) 8889 3099

E: info@kingspanpanels.com.au
kingspanpanels.com.au



Please scan for the most
up to date version of this
Product Data Sheet.

For the product offering in other markets please contact your local sales representative or visit www.kingspanpanels.com

Care has been taken to ensure that the contents of this publication are accurate, but Kingspan Limited and its subsidiary companies do not accept responsibility for errors or for information that is found to be misleading. Suggestions for, or description of, the end use or application of products or methods of working are for information only and Kingspan Limited and its subsidiaries accept no liability in respect thereof.

